



**ACF**

VENTILATOREN



***Radialventilator  
Baureihe: RU***

# RU

**VENTILATORE AD ALTO RENDIMENTO**  
*HIGH EFFICIENCY FAN*



**GIRANTE A PALE CURVE ROVESCE**  
**BACKWARD CURVED BLADES IMPELLER**

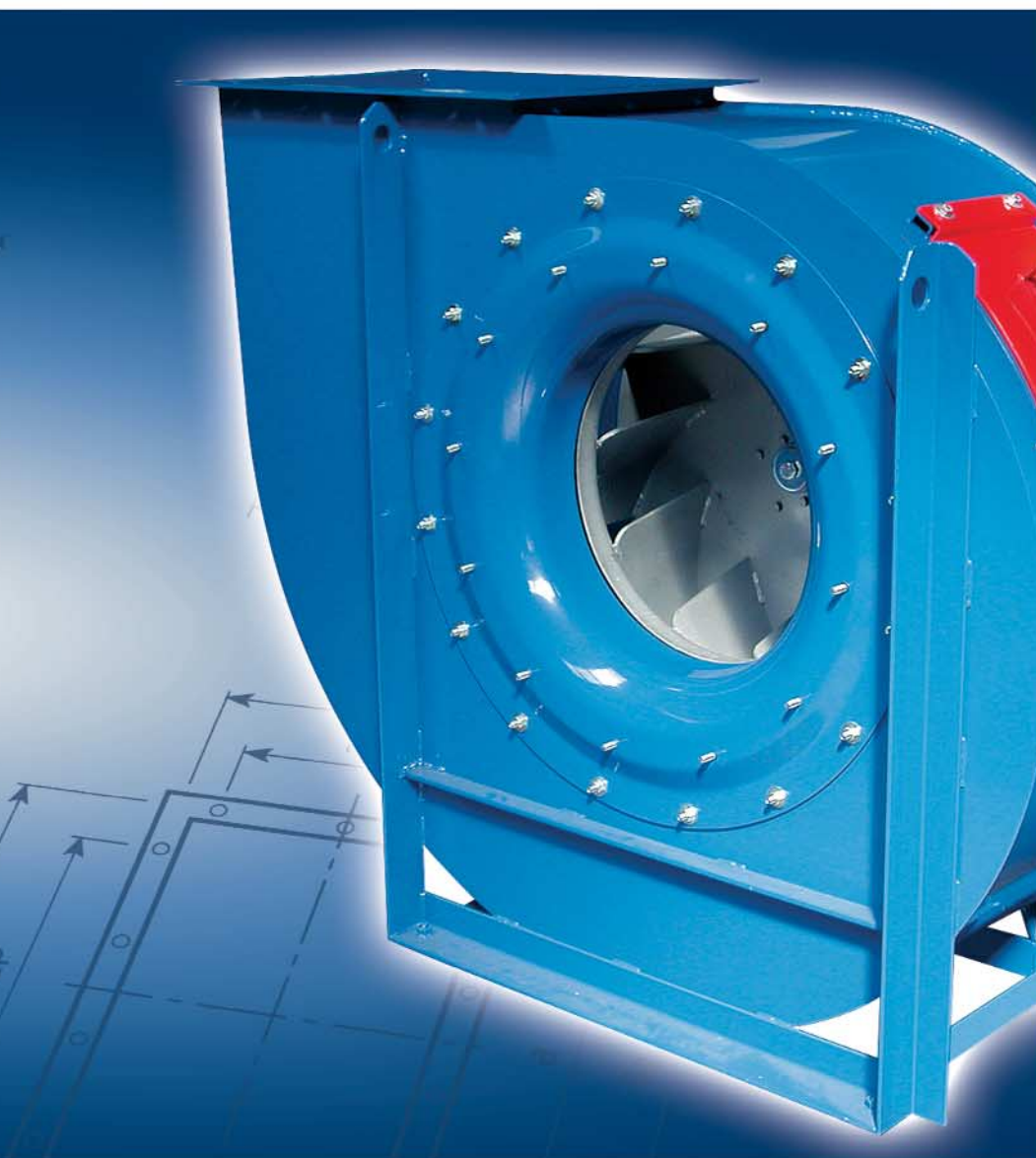

**MEDIA PRESSIONE**  
**MEDIUM PRESSURE**

**Portata/Flow rate:**  
**360 ÷ 120000 m<sup>3</sup>/h**

**Pressione/Pressure:**  
**40 ÷ 650 mm H<sub>2</sub>O**



**ACF**



**Ihr Partner für Ventilatoren**  
Stahl | Edelstahl | Aluminium Kunststoff

# RU

## VENTILATORE AD ALTO RENDIMENTO HIGH EFFICIENCY FAN



### **Ventilatore ad alto rendimento: Mod. RU.**

Campo di lavoro: portate elevate, pressioni medie, rendimento elevato.

Tipo di pale: rovesce.

Applicazioni: aspirazione e trasporto di aria anche molto polverosa, trasporto pneumatico, impianti di essiccazione, segatura, trucioli vari, materiali granulari, ad esclusione dei materiali filamentosi.

Temperatura del fluido: fino a 60° C in esecuzione standard; esecuzioni speciali per temperature superiori.

Caratteristiche costruttive: costruzione robusta in lamiera verniciata, ventola in acciaio equilibrata staticamente e dinamicamente.

Caratteristiche di funzionamento:

condizioni dell'aria in aspirazione  $T = 15^{\circ} \text{C}$ ,  $p = 1 \text{ atm}$ .

### **High efficiency fan: Mod. RU.**

*Field of application: high capacities, medium pressures, high performance.*

*Type of blades: backward.*

*Applications: suction and transport of air, pneumatic transport, drying systems, sawdust, woodchips, granulated materials with the exclusion of fibrous materials.*

*Air temperature: up to 60° C standard, special features for higher temperatures.*

*Construction specifications: rigid construction in sheet metal.*

*Statically and dynamically balanced impellers.*

*Working principles: condition of the ducted air  $T = 15^{\circ} \text{C}$ ,  $p = 1 \text{ atm}$ .*



**Orientamento RD 270**  
Position RD 270

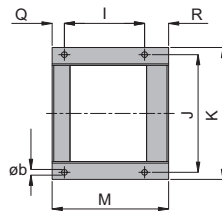
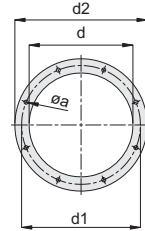
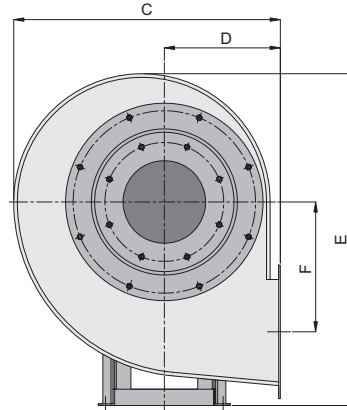
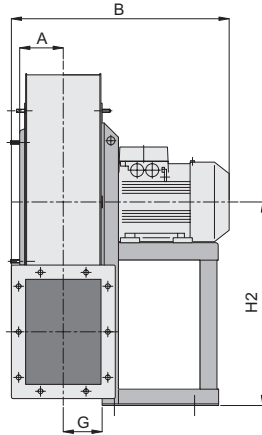
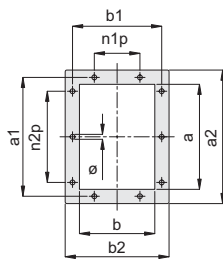

### RU 250÷500

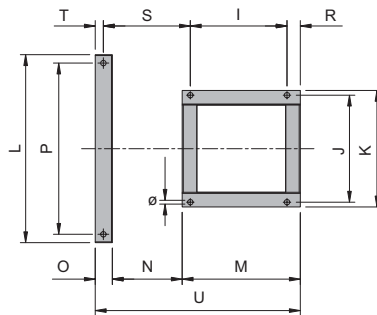
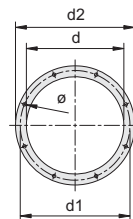
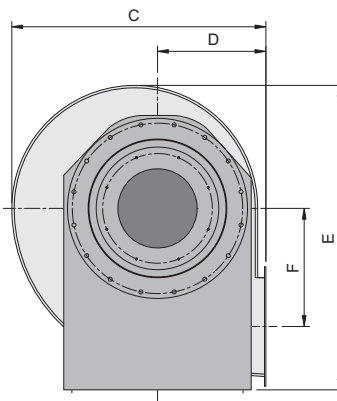
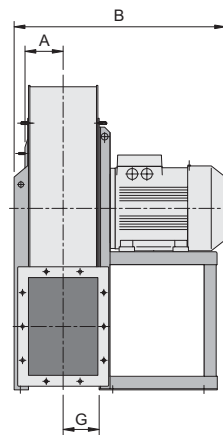
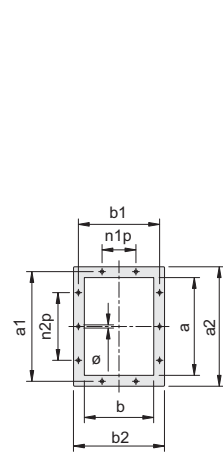

### RU 560÷630

**Direzioni di rotazione (vista lato motore) - Rotation senses (seen from motor side)**

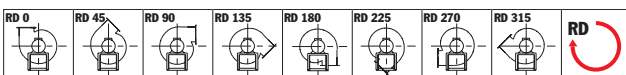

Rotazione oraria - Clockwise rotation sense

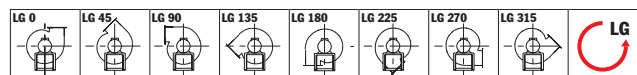

Rotazione anti-oraria - Anti-Clockwise rotation sense

# DIMENSIONI D'INGOMBRO

## OVERALL DIMENSIONS



# RU 250÷630

Peso ventilatore in Kgf (completo di motore) - Weight of ventilator (complete with motor)

NOTA: quota B indicativa - NOTE: "B" quote indicative

TIPO - TYPE		PESO WEIGHT	PD² GD²	VENTILATORE FAN									
VENTILATORE FAN	MOTORE MOTOR			kgf	kgf m²	A	B	C	D	E	F	G	H
<b>RU 250</b>	<b>71 A2</b>	25	0,11	86	400	441	195	526	175	76	315	195	315
<b>RU 280</b>	<b>71 B2</b>	30	0,13	95	420	477	200	610	202	86	375	200	375
<b>RU 310</b>	<b>80 B2</b>	40	0,25	105	460	527	225	658	229	96	400	225	400
<b>RU 350</b>	<b>90 L2</b>	67	0,42	115	530	600	255	740	253	107	450	255	450
<b>RU 400</b>	<b>112 M2</b>	105	0,78	127	630	655	285	815	286	118	500	285	500
<b>RU 450</b>	<b>132 SB2</b>	150	1,22	140	670	735	320	915	321	131	560	320	560
<b>RU 501</b>	<b>160 MR2</b>	230	2,3	159	830	832	360	1000	355	148	600	360	600
<b>RU 502</b>	<b>90 S4</b>	128	2,4		580								
<b>RU 561</b>	<b>160 M2</b>	282	3,5	180	880	940	400	1126	390	165	670	400	670
<b>RU 562</b>	<b>160 L2</b>	292	3,8		880								
<b>RU 563</b>	<b>100 LA4</b>	138	3,65		705								
<b>RU 631</b>	<b>200 LR2</b>	380	5,5	200	1080	1052	450	1260	439	185	750	450	750
<b>RU 632</b>	<b>200 L2</b>	390	5,9		1080								
<b>RU 633</b>	<b>112 M4</b>	175	5,7		775								

TIPO - TYPE	FLANGIA ASPIRANTE INLET FLANGE					FLANGIA PREMENTE OUTLET FLANGE								BASAMENTO BASE																
	VENTILATORE FAN	d	d <sub>1</sub>	d <sub>2</sub>	n°	∅	a	b	a <sub>1</sub>	b <sub>1</sub>	a <sub>2</sub>	b <sub>2</sub>	n <sub>1</sub> xp	n <sub>2</sub> xp	n°	∅	I	J	K	L	M	N	O	P	Q	R	S	T	U	∅
<b>RU 250</b>		205	241	275	8	8	207	148	241	182	277	218	1x112	1x112	8	12	121	203	225	-	189	-	-	-	45	23	-	-	-	10
<b>RU 280</b>		228	265	298	8	8	231	166	265	200	301	236	1x112	1x112	8	12	121	203	225	-	189	-	-	-	45	23	-	-	-	10
<b>RU 310</b>		255	292	325	8	10	258	185	292	219	328	255	1x112	2x112	10	12	121	203	225	-	211	-	-	-	45	45	-	-	-	10
<b>RU 350</b>		285	332	365	8	10	288	205	332	249	368	285	1x125	2x125	10	12	133	234	260	-	246	-	-	-	55	58	-	-	-	10
<b>RU 400</b>		320	366	400	8	10	322	229	366	273	402	309	1x125	2x125	10	12	197	289	324	-	276	-	-	-	30	49	-	-	-	12
<b>RU 450</b>		360	405	440	8	10	361	256	405	300	441	336	1x125	2x125	10	12	237	337	372	-	336	-	-	-	40	59	-	-	-	12
<b>RU 501</b>		405	448	485	12	10	404	288	448	332	484	368	2x125	3x125	14	12	337	395	440	-	436	-	-	-	50	49	-	-	-	14
<b>RU 502</b>																	133	234	260	-	246	-	-	-	55	58	-	-	-	
<b>RU 561</b>		455	497	535	12	10	453	322	497	366	533	402	2x125	3x125	14	12	337	395	440	-	436	-	-	-	28	406	-	-	794	14
<b>RU 562</b>																	337	395	440	692	436	326	53	632	-	28	406	23	794	14
<b>RU 563</b>																	197	289	324	276	23	386	-	-	23	386	-	-	629	12
<b>RU 631</b>		505	551	585	12	10	507	361	551	405	587	441	2x125	3x125	14	12	381	506	568	-	500	-	-	-	49	475	-	-	918	20
<b>RU 632</b>																	381	506	568	752	500	363	53	702	-	49	475	23	918	20
<b>RU 633</b>																	197	289	324	250	49	425	-	-	49	425	-	-	668	12

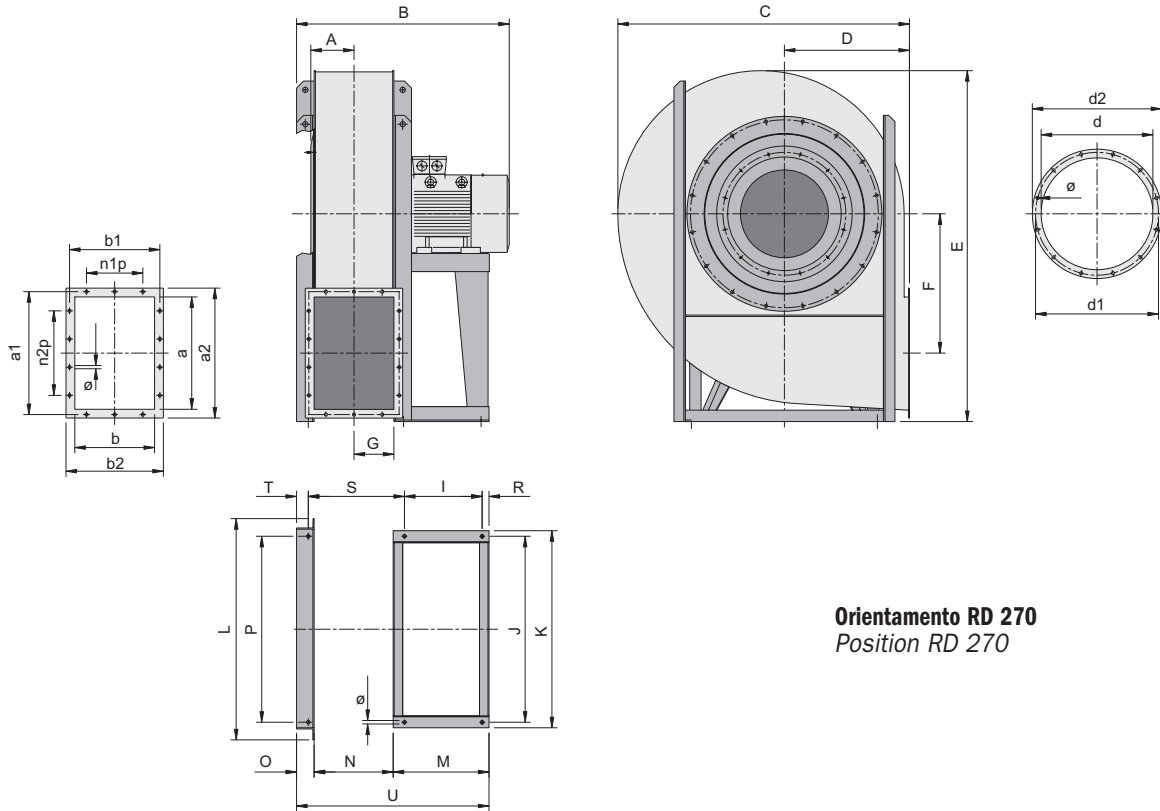

**Orientamento RD 270**  
Position RD 270

# RU 710÷1600

### Direzioni di rotazione (vista lato motore) - Rotation senses (seen from motor side)

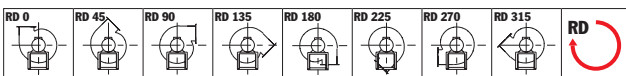

**Rotazione oraria** - Clockwise rotation sense

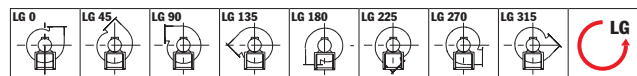

**Rotazione anti-oraria** - Anti-Clockwise rotation sense

# DIMENSIONI D'INGOMBRO

## OVERALL DIMENSIONS



# RU 710÷1600

Peso ventilatore in Kgf (completo di motore) - Weight of ventilator (complete with motor)

NOTA: quota B indicativa - NOTE: "B" quote indicative

TIPO - TYPE		PESO WEIGHT	PD² GD²	VENTILATORE FAN										
VENTILATORE FAN	MOTORE MOTOR			kgf	kgf m²	A	B	C	D	E	F	G	H	H <sub>1</sub>
<b>RU 711</b>	<b>132 SA4</b>	270	10,5		880									
<b>RU 712</b>	<b>132 MA4</b>	281	11,5	221	920	1189	500	1416	500	202	670	500	850	
<b>RU 801</b>	<b>132 MB4</b>	327	18		940									
<b>RU 802</b>	<b>160 M4</b>	397	20	246	1010	1340	560	1591	560	226	755	560	950	
<b>RU 803</b>	<b>132 MA6</b>	337	19		940									
<b>RU 901</b>	<b>180 M4</b>	416	34		1110									
<b>RU 902</b>	<b>200 L4</b>	671	37,5	277	1230	1500	630	1780	630	253	850	630	1060	
<b>RU 903</b>	<b>160 M6</b>	486	36,5		1070									
<b>RU 1001</b>	<b>225 S4</b>	749	71		1295									
<b>RU 1002</b>	<b>225 M4</b>	759	78	308	1320	1685	710	1993	710	284	950	710	1180	
<b>RU 1003</b>	<b>160 L6</b>	612	76		1190									
<b>RU 1004</b>	<b>180 L6</b>	642	69		1230									
<b>RU 1121</b>	<b>250 M4</b>	1140	90,5		1580									
<b>RU 1122</b>	<b>280 S4</b>	1212	96	343	1620	1884	800	2222	800	319	1060	800	1320	
<b>RU 1123</b>	<b>200 LR6</b>	967	86		1390									
<b>RU 1124</b>	<b>200 L6</b>	987	90,5		1390									
<b>RU 1251</b>	<b>315 S4</b>	1470	151		1660									
<b>RU 1252</b>	<b>315 M4</b>	1530	172	387	1710	2116	900	2517	900	357	1190	900	1500	
<b>RU 1253</b>	<b>225 M6</b>	1220	151		1460									
<b>RU 1254</b>	<b>250 M6</b>	1316	161		1550									
<b>RU 1401</b>	<b>280 S6</b>	1834	262	430	1790	2365	1000	2816	1000	400	1320	1000	1700	
<b>RU 1402</b>	<b>315 S6</b>	1954	270		1800									

TIPO - TYPE	FLANGIA ASPIRANTE INLET FLANGE					FLANGIA PREMENTE OUTLET FLANGE										BASAMENTO BASE														
	VENTILATORE FAN	d	d <sub>1</sub>	d <sub>2</sub>	n°	∅	a	b	a <sub>1</sub>	b <sub>1</sub>	a <sub>2</sub>	b <sub>2</sub>	n.xp	n.xp	n°	∅	I	J	K	L	M	N	O	P	Q	R	S	T	U	∅
<b>RU 711</b>		565	629	665	12	10	569	404	629	464	669	504	2x160	3x160	14	14	201	772	826	915	336	404	60	772	-	59	497	27	764	20
<b>RU 712</b>																	201				336					59				833
<b>RU 801</b>		635	698	735	12	12	638	453	698	513	738	553	2x160	3x160	14	14	315	862	926	1045	436	453	80	862	-	49	546	47	948	20
<b>RU 802</b>																	201				336					59				833
<b>RU 803</b>																					336					59				833
<b>RU 901</b>		715	775	815	16	12	715	507	775	567	815	607	2x160	4x160	16	14	361	962	1026	1145	460	507	80	962	-	39	600	47	1047	20
<b>RU 902</b>																	401				500					39				1087
<b>RU 903</b>																	316				436					49				1002
<b>RU 1001</b>		805	861	905	16	12	801	569	871	639	921	689	2x200	3x200	14	14	440				540					45				1209
<b>RU 1002</b>																	440				540					45				1209
<b>RU 1003</b>																	315	1056	1128	1255	436	569	100	1056	-	49	657	67	1084	20
<b>RU 1004</b>																	360				460					45				1129
<b>RU 1121</b>		905	958	1005	16	12	898	638	968	708	1018	758	3x200	4x200	18	14	475				600					45				1338
<b>RU 1122</b>																	565				690					45				1428
<b>RU 1123</b>																	375	1178	1268	1400	500	638	100	1178	-	45	763	55	1238	24
<b>RU 1124</b>																	375				500					45				1238
<b>RU 1251</b>		1007	1067	1107	24	12	1007	715	1077	785	1127	835	3x200	4x200	18	14	675				800					45				1615
<b>RU 1252</b>																	675				800					45				1615
<b>RU 1253</b>																	415	1310	1400	1530	540	715	100	1310	-	45	840	55	1355	24
<b>RU 1254</b>																	475				600					45				1415
<b>RU 1401</b>		1130	1200	1250	24	12	1130	801	1210	881	1270	941	3x200	5x200	20	18	535	1450	1560	1690	690	801	130	1450	-	55	946	85	1621	24
<b>RU 1402</b>																	645				800					55				1731









# PRESTAZIONI VENTILATORI A TRASMISSIONE BELT BELT DRIVEN FANS PERFORMANCES



## RU 250T

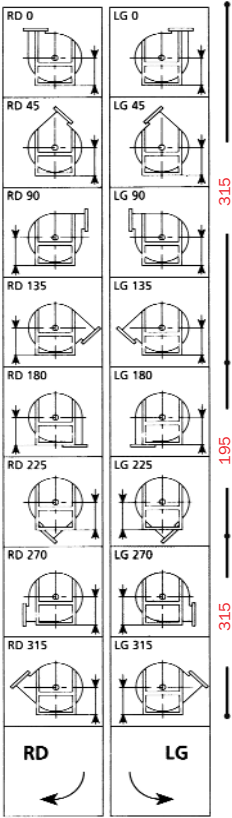

**Il ventilatore è orientabile**  
*The fan is revolvable*

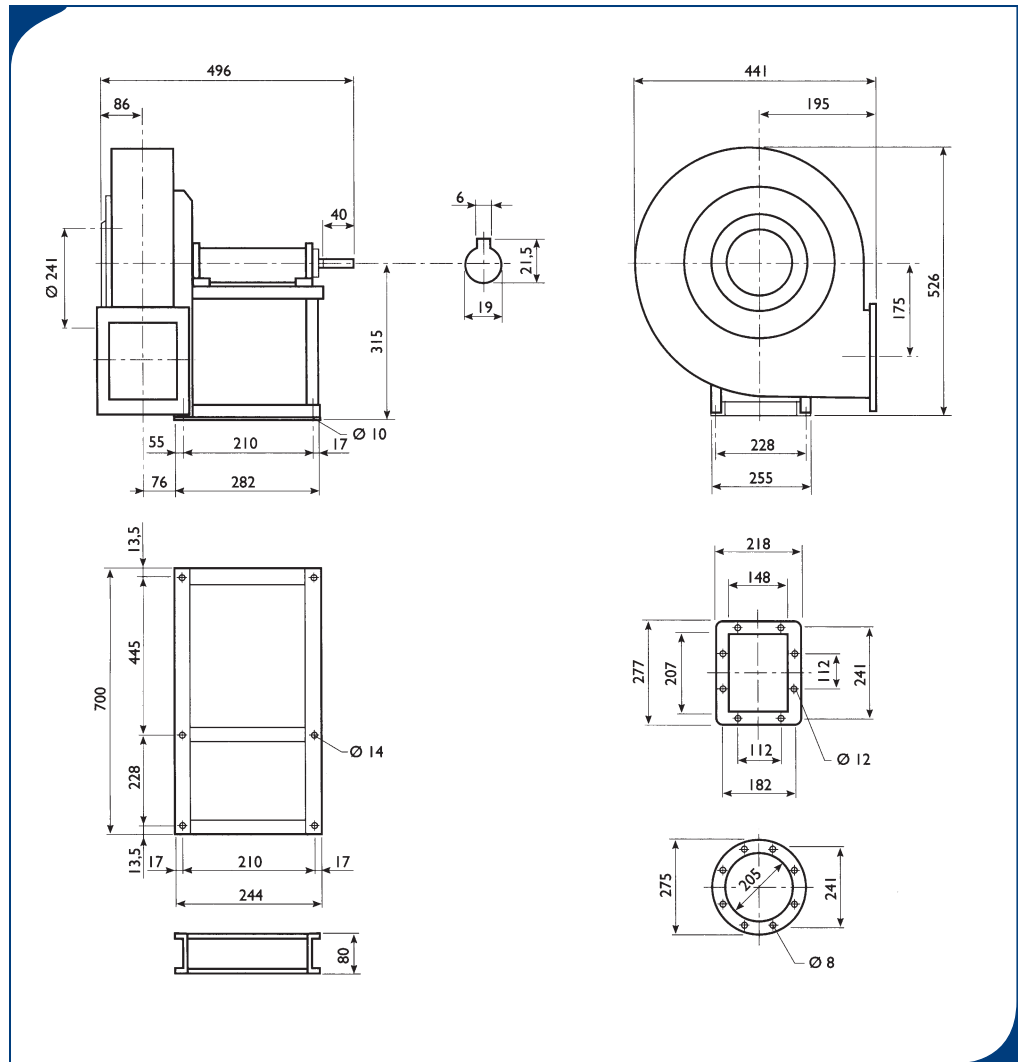

**Peso ventilatore in kgf 25**  
*Weight of ventilator in kgf 25*

**PD<sup>2</sup> = 0,11 kgf m<sup>2</sup>**  
**GD<sup>2</sup> = 0,11 kgf m<sup>2</sup>**

**Massima velocità di rotazione**  
*Maximum rotation speed*

<100°C = 5000  
100÷200°C = 4500  
200÷300°C = 4000

**Tolleranza sulla rumorosità + 3 dB(A)**  
*Noise tolerance + 3 dB(A)*

**Tolleranza sulla potenza assorbita ± 3%**  
*Absorbed power tolerance ± 3%*

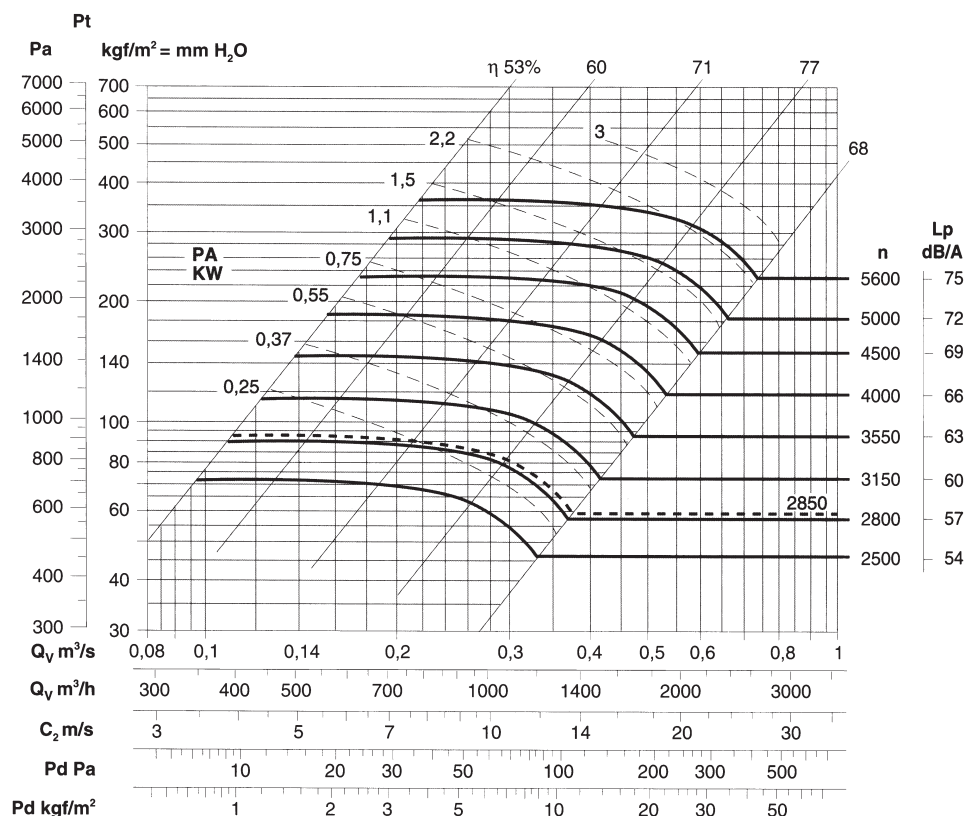



# PRESTAZIONI VENTILATORI A TRASMISSIONE

## BELT DRIVEN FANS PERFORMANCES

### RU 280T

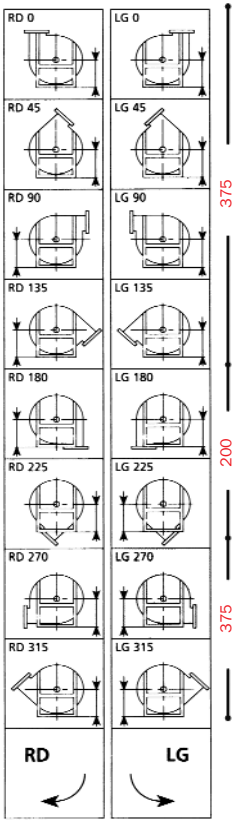

Il ventilatore è orientabile  
The fan is revolvable

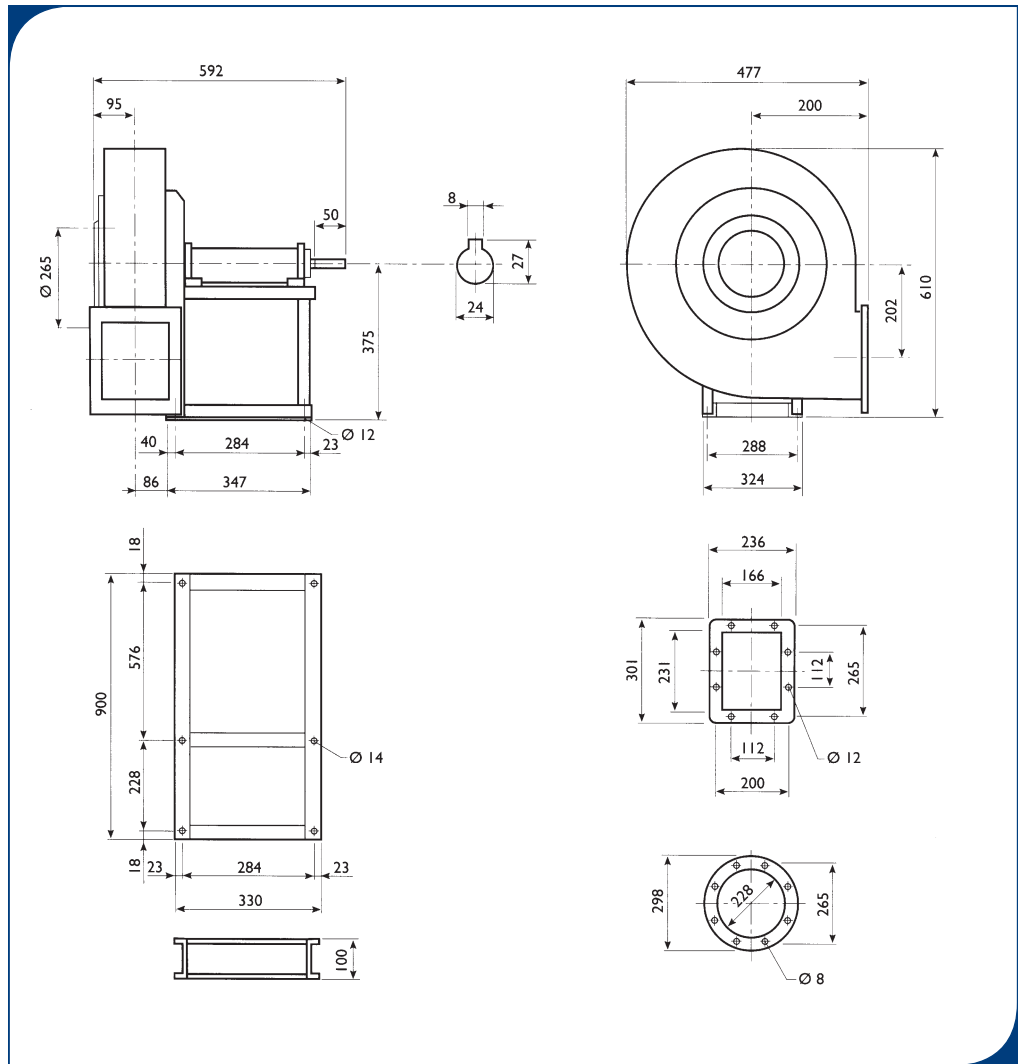

**Peso ventilatore in kgf 36**  
Weight of ventilator in kgf 36

**PD<sup>2</sup> = 0,13 kgf m<sup>2</sup>**  
**GD<sup>2</sup> = 0,13 kgf m<sup>2</sup>**

**Massima velocità di rotazione**  
Maximum rotation speed

<100°C = 4750  
100÷200°C = 4250  
200÷300°C = 3700

**Tolleranza sulla rumorosità + 3 dB(A)**  
Noise tolerance + 3 dB(A)

**Tolleranza sulla potenza assorbita ± 3%**  
Absorbed power tolerance ± 3%

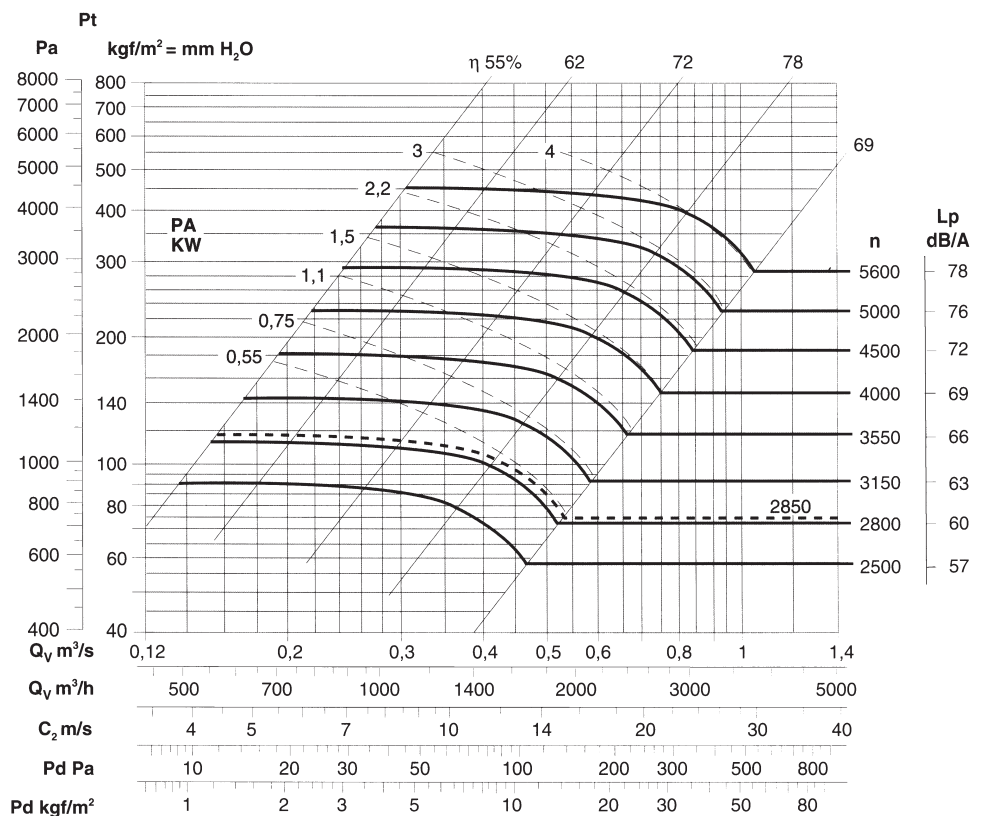

# PRESTAZIONI VENTILATORI A TRASMISSIONE

## BELT DRIVEN FANS PERFORMANCES



### RU 310T

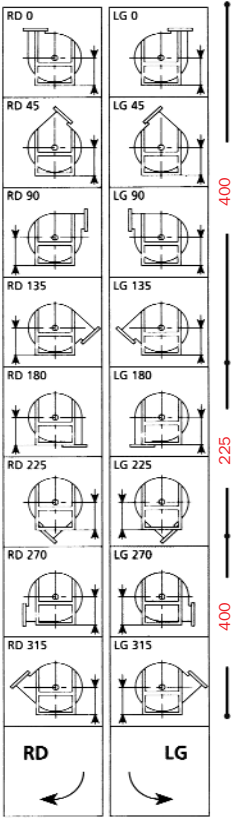

**Il ventilatore è orientabile**  
The fan is revolvable

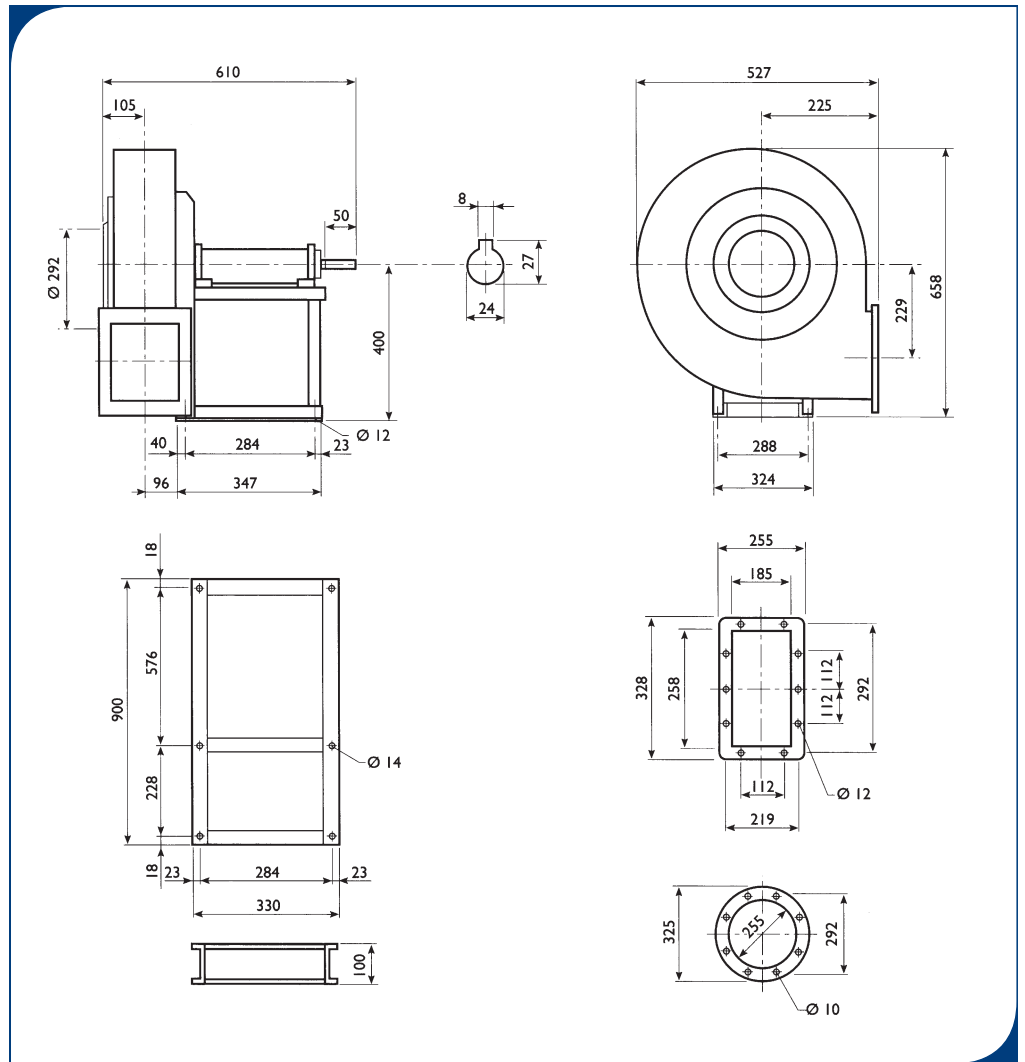

**Peso ventilatore in kgf 43**  
Weight of ventilator in kgf 43

**PD<sup>2</sup> = 0,25 kgf m<sup>2</sup>**  
**GD<sup>2</sup> = 0,25 kgf m<sup>2</sup>**

**Massima velocità di rotazione**  
Maximum rotation speed

<100°C = 4500  
100÷200°C = 4000  
200÷300°C = 3500

**Tolleranza sulla rumorosità + 3 dB(A)**  
Noise tolerance + 3 dB(A)

**Tolleranza sulla potenza assorbita ± 3%**  
Absorbed power tolerance ± 3%

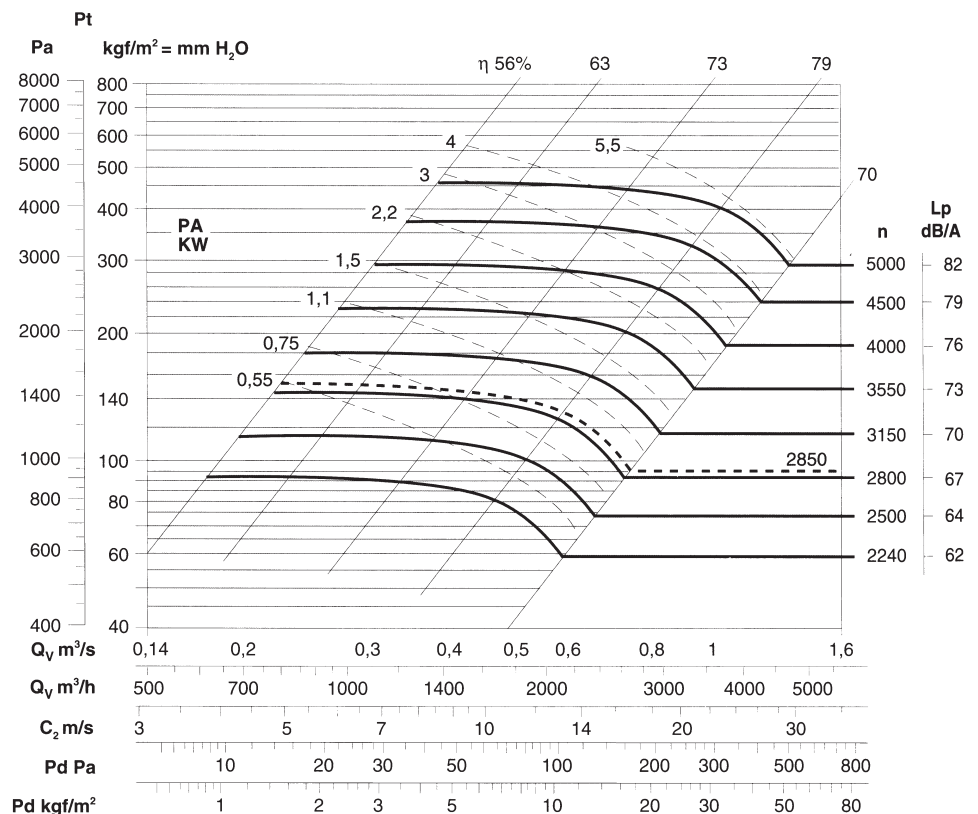



# PRESTAZIONI VENTILATORI A TRASMISSIONE BELT DRIVEN FANS PERFORMANCES

## RU 350T

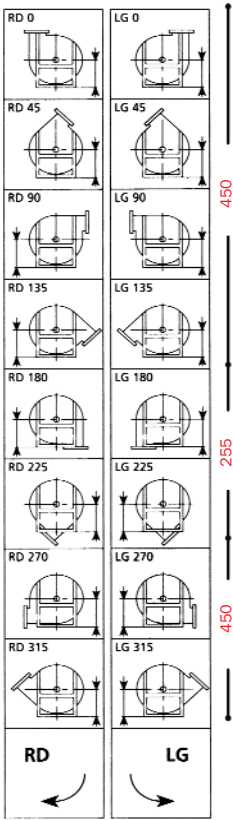

Il ventilatore è orientabile  
The fan is revolvable

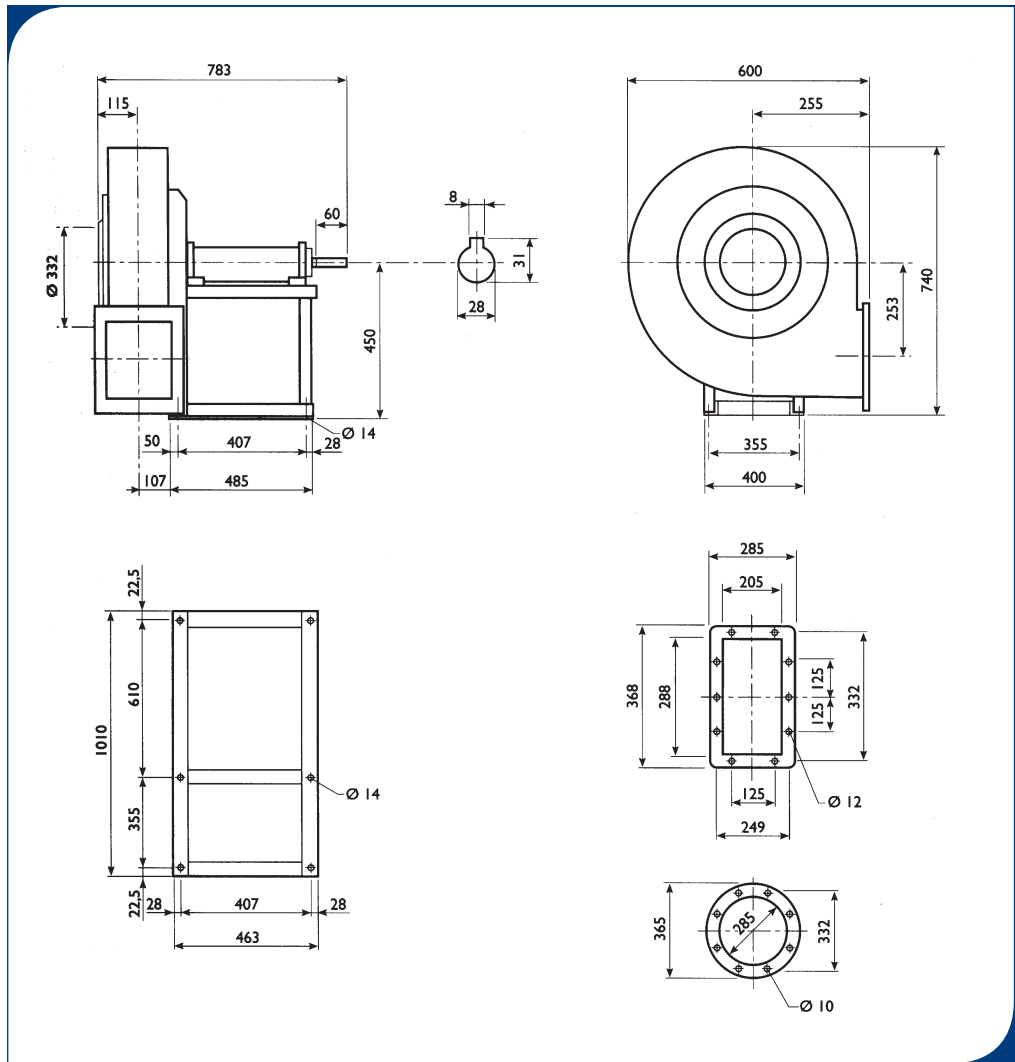

**Peso ventilatore in kgf 72**  
Weight of ventilator in kgf 72

**PD<sup>2</sup> = 0,42 kgf m<sup>2</sup>**  
GD<sup>2</sup> = 0,42 kgf m<sup>2</sup>

**Massima velocità di rotazione**  
Maximum rotation speed

<100°C = 4200  
100÷200°C = 3750  
200÷300°C = 3300

**Tolleranza sulla rumorosità + 3 dB(A)**  
Noise tolerance + 3 dB(A)

**Tolleranza sulla potenza assorbita ± 3%**  
Absorbed power tolerance ± 3%

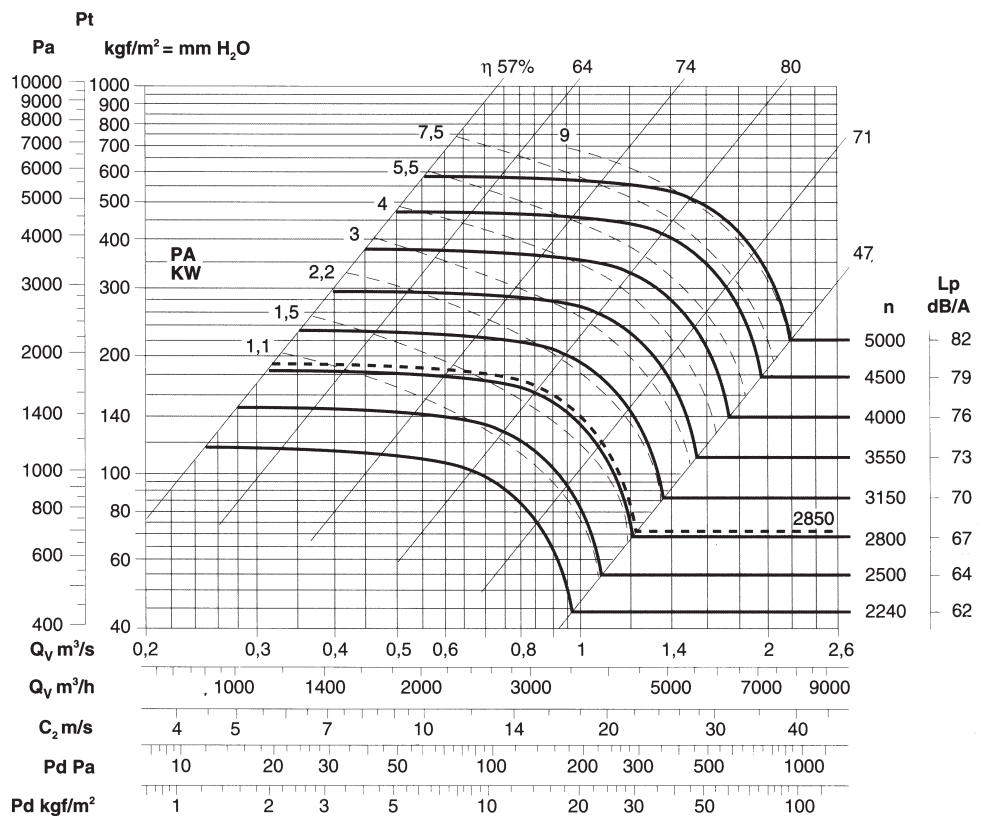

# PRESTAZIONI VENTILATORI A TRASMISSIONE BELT BELT DRIVEN FANS PERFORMANCES



## RU 400T

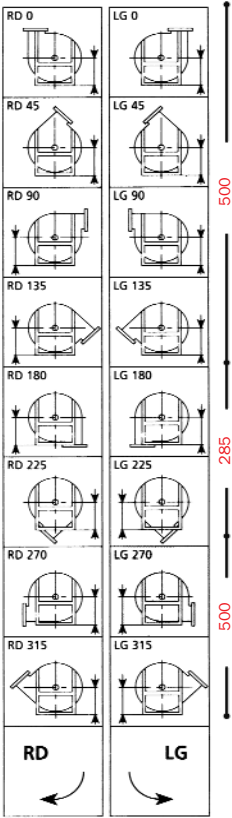

**Il ventilatore è orientabile**  
*The fan is revolvable*

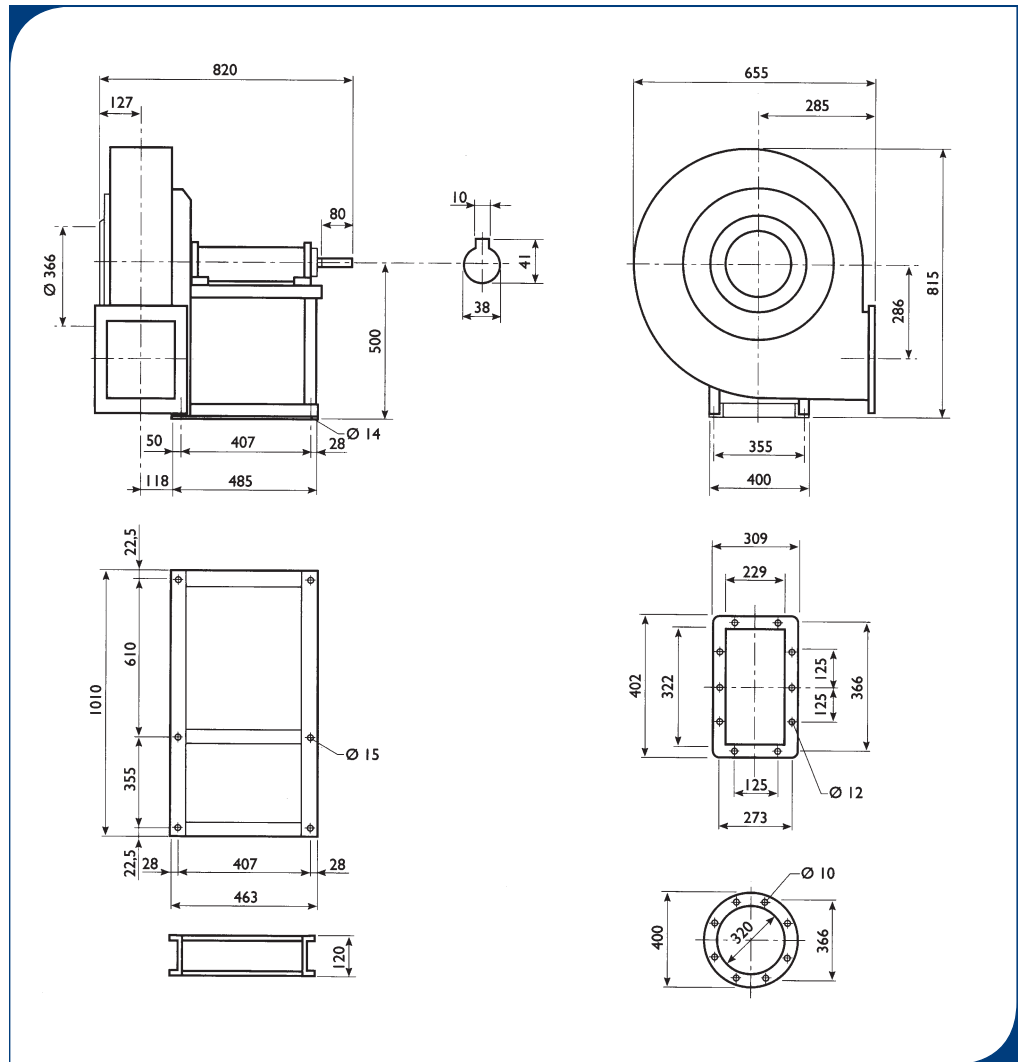

**Peso ventilatore in kgf 85**  
*Weight of ventilator in kgf 85*

**PD<sup>2</sup> = 0,78 kgf m<sup>2</sup>**

**Massima velocità di rotazione**  
*Maximum rotation speed*

<100°C = 3900  
100÷200°C = 3550  
200÷300°C = 3150

**Tolleranza sulla rumorosità + 3 dB(A)**  
*Noise tolerance + 3 dB(A)*

**Tolleranza sulla potenza assorbita ± 3%**  
*Absorbed power tolerance ± 3%*

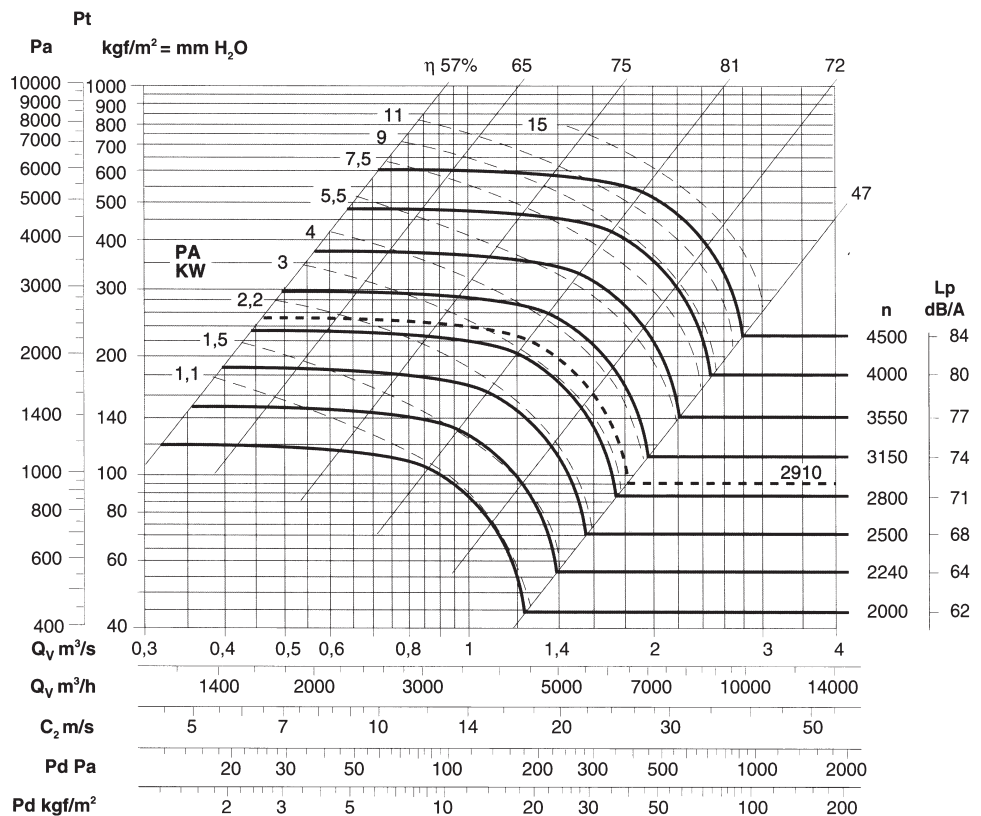





# PRESTAZIONI VENTILATORI A TRASMISSIONE

## BELT DRIVEN FANS PERFORMANCES

### RU 450T

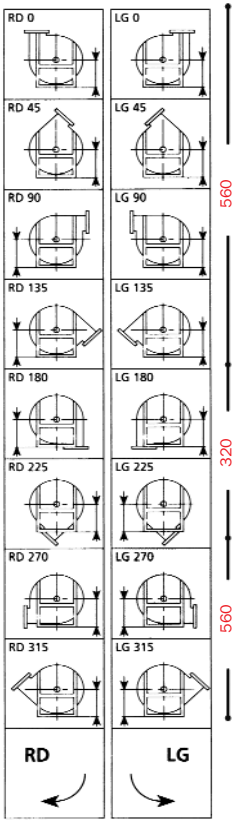

Il ventilatore **non** è orientabile  
The fan is **not** revolvable

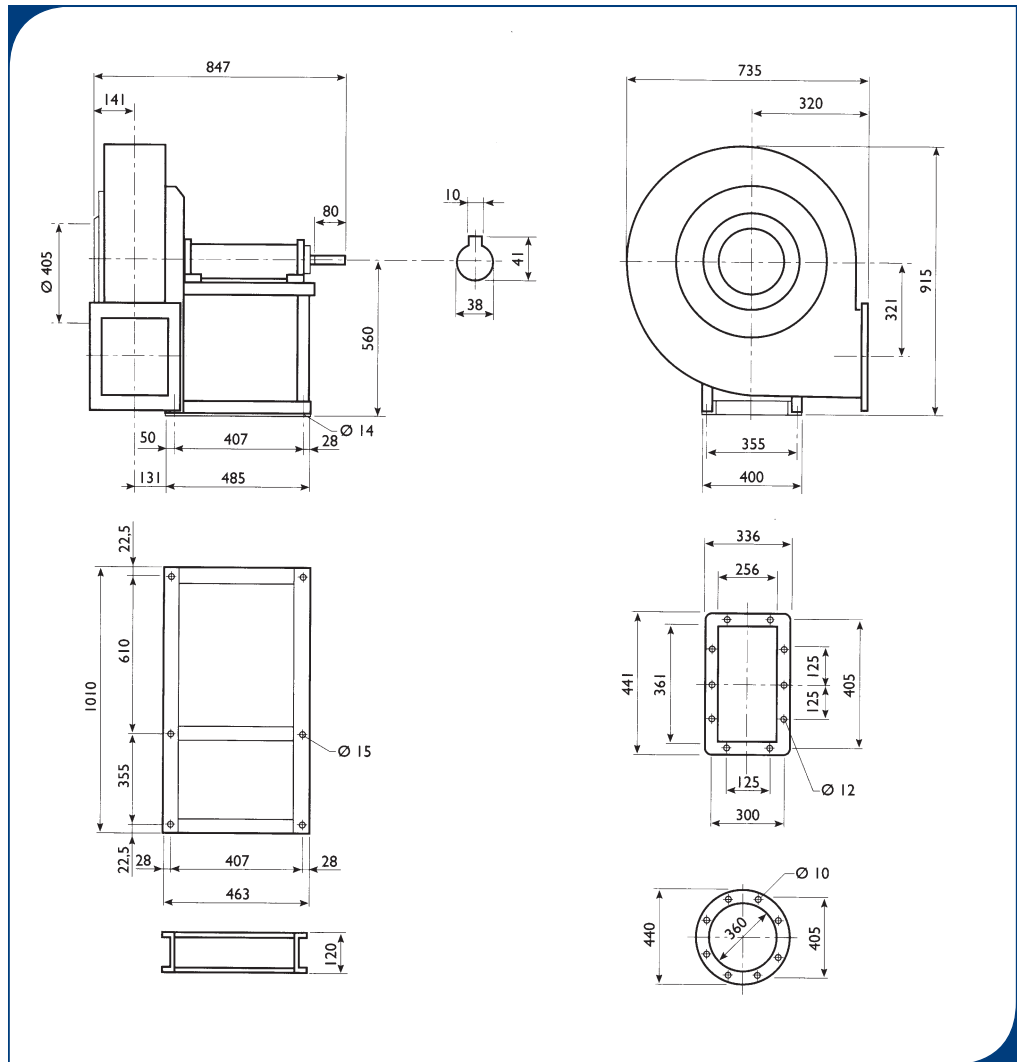

**Peso ventilatore in kgf 102**  
Weight of ventilator in kgf 102

**PD<sup>2</sup> = 1,22 kgf m<sup>2</sup>**  
**GD<sup>2</sup> = 1,22 kgf m<sup>2</sup>**

**Massima velocità di rotazione**  
Maximum rotation speed

<100°C = 3650  
100÷200°C = 3300  
200÷300°C = 2900

**Tolleranza sulla rumorosità + 3 dB(A)**  
Noise tolerance + 3 dB(A)

**Tolleranza sulla potenza assorbita ± 3%**  
Absorbed power tolerance ± 3%

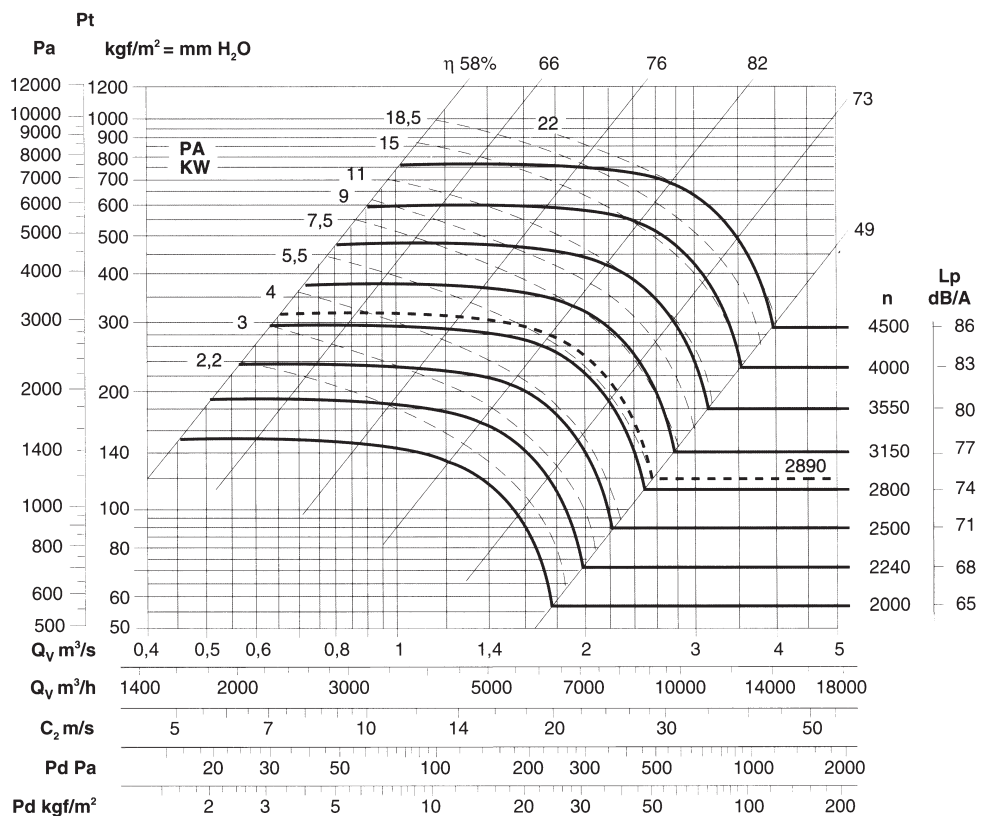

# PRESTAZIONI VENTILATORI A TRASMISSIONE BELT BELT DRIVEN FANS PERFORMANCES



## RU 500T

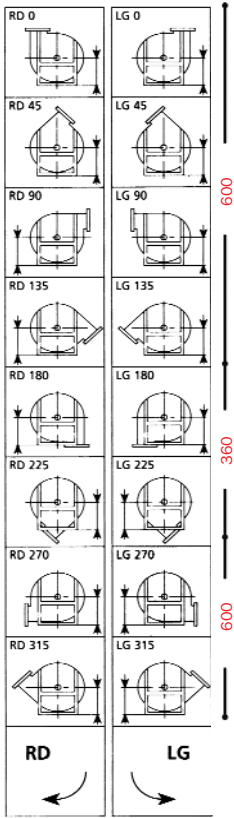

Il ventilatore **non** è orientabile  
The fan is **not** revolvable

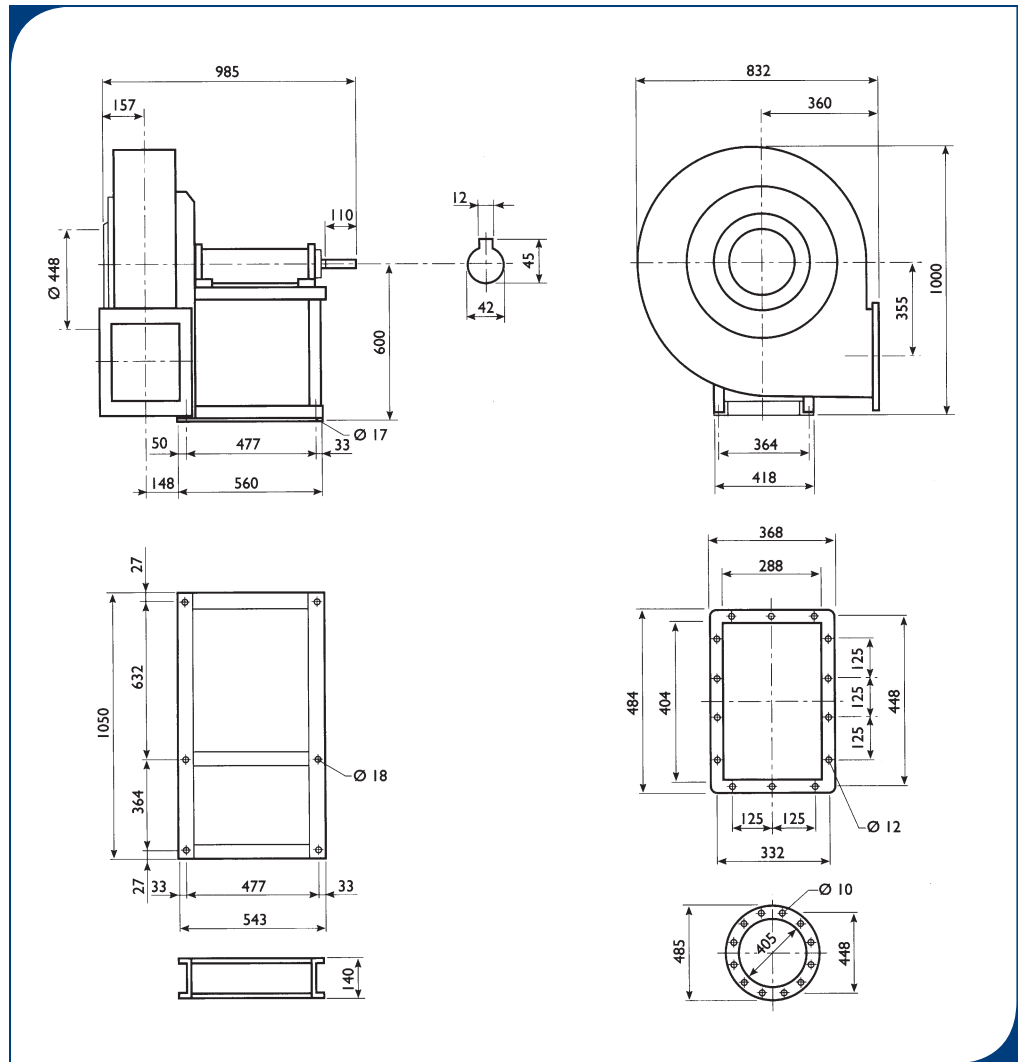

**Peso ventilatore in kgf 145**  
Weight of ventilator in kgf 145

**PD<sup>2</sup> = 2,3 kgf m<sup>2</sup>**  
**GD<sup>2</sup> = 2,3 kgf m<sup>2</sup>**

**Massima velocità di rotazione**  
Maximum rotation speed

<100°C = 3400  
100÷200°C = 3150  
200÷300°C = 2800

**Tolleranza sulla rumorosità + 3 dB(A)**  
Noise tolerance + 3 dB(A)

**Tolleranza sulla potenza assorbita ± 3%**  
Absorbed power tolerance ± 3%

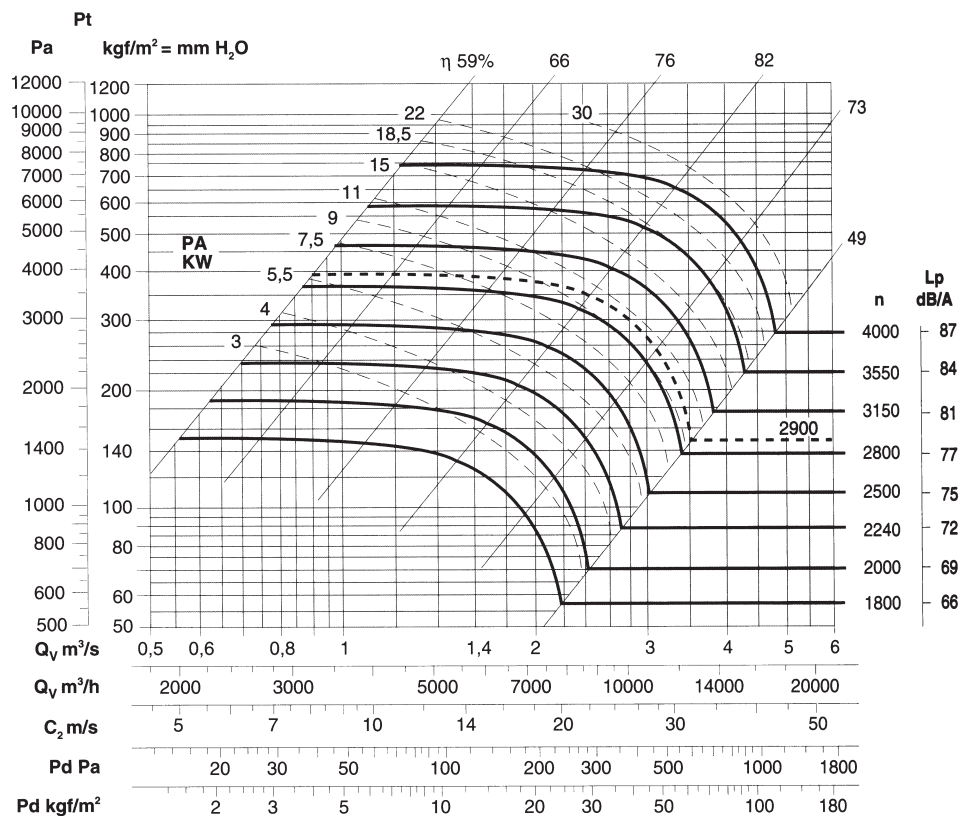



# PRESTAZIONI VENTILATORI A TRASMISSIONE

## BELT DRIVEN FANS PERFORMANCES

### RU 560T

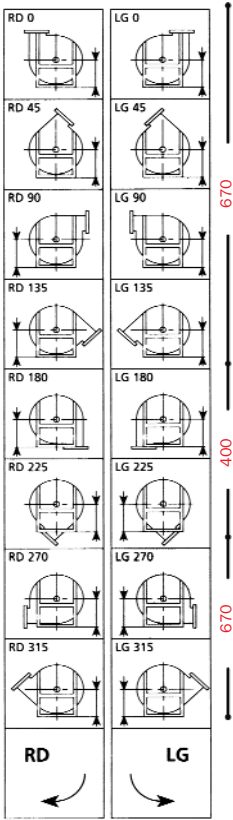

Il ventilatore **non** è orientabile  
The fan is **not** revolvable

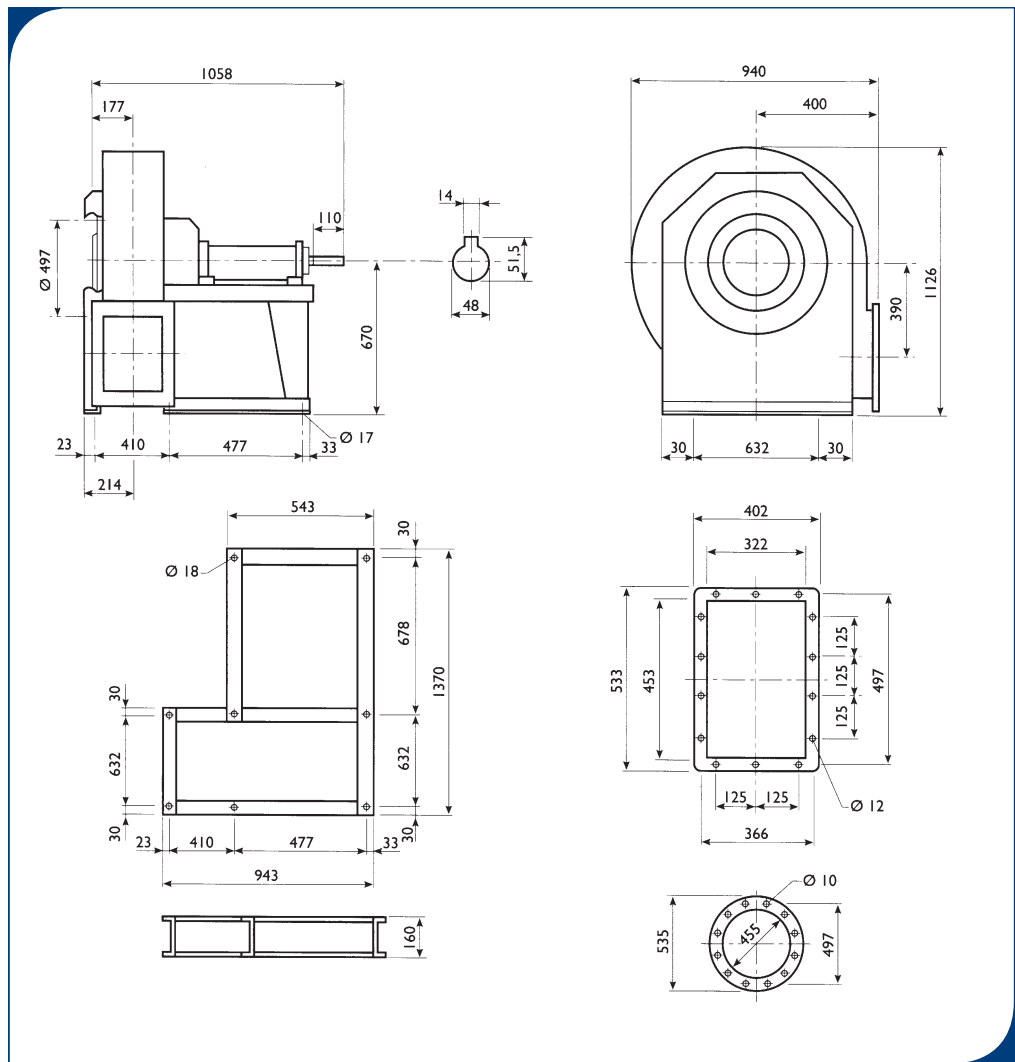

**Peso ventilatore in kgf 172**  
Weight of ventilator in kgf 172

**PD<sup>2</sup> = 3,65 kgf m<sup>2</sup>**  
**GD<sup>2</sup> = 3,65 kgf m<sup>2</sup>**

**Massima velocità di rotazione**  
Maximum rotation speed

<100°C = 3150  
100÷200°C = 2800  
200÷300°C = 2400

**Tolleranza sulla rumorosità + 3 dB(A)**  
Noise tolerance + 3 dB(A)

**Tolleranza sulla potenza assorbita ± 3%**  
Absorbed power tolerance ± 3%

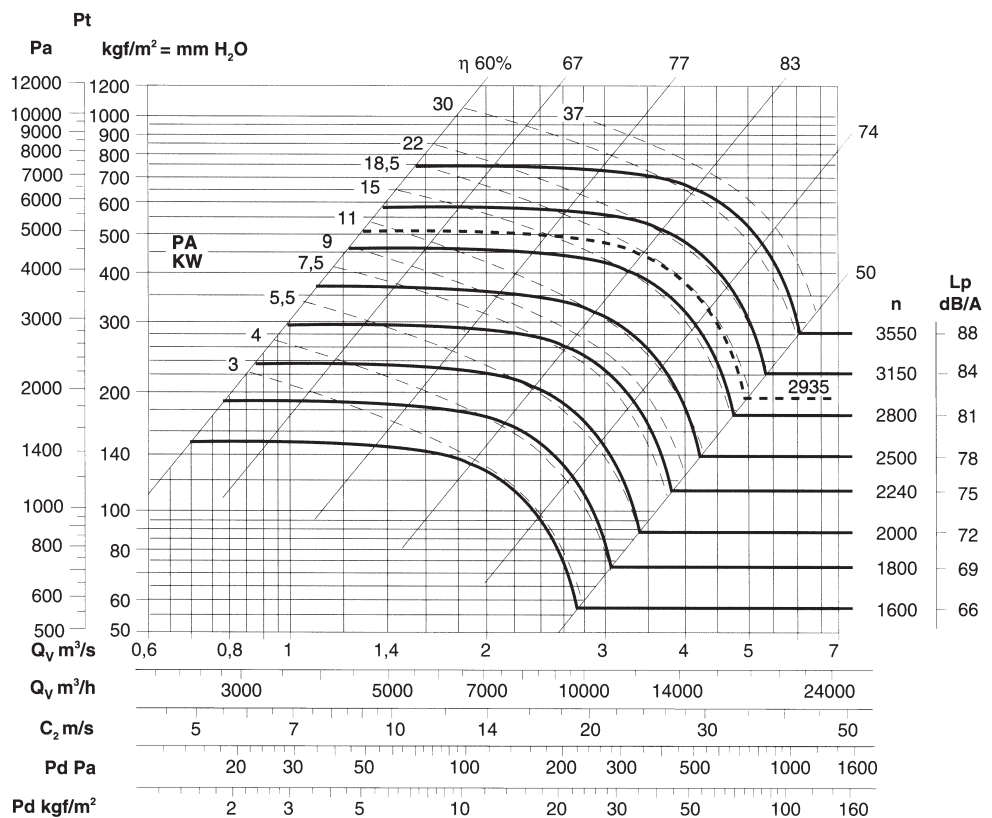

# PRESTAZIONI VENTILATORI A TRASMISSIONE BELT BELT DRIVEN FANS PERFORMANCES



## RU 630T

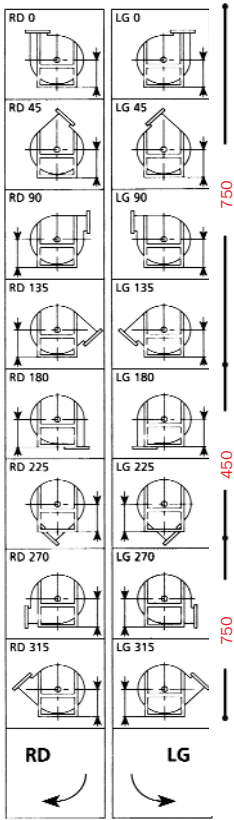

Il ventilatore **non** è orientabile  
The fan is **not** revolvable

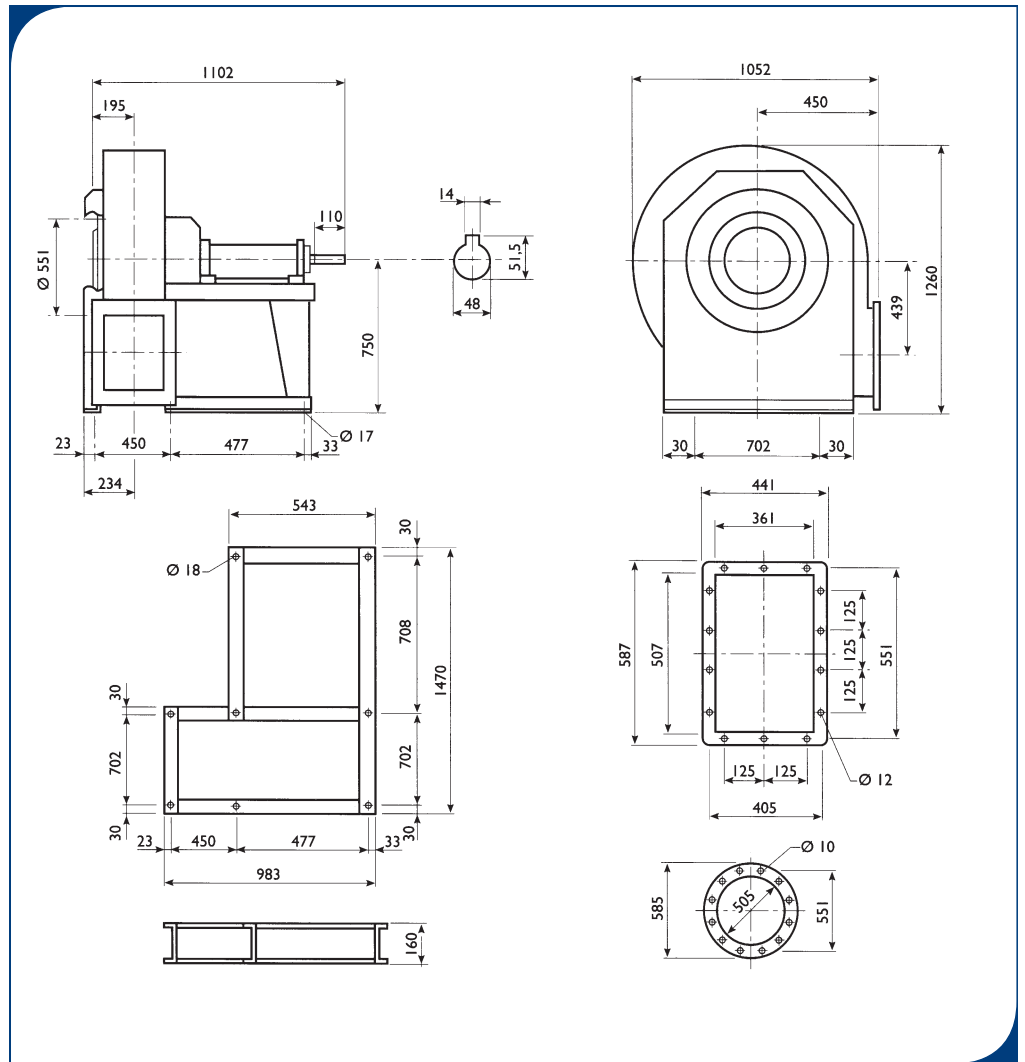

**Peso ventilatore in kgf 210**  
Weight of ventilator in kgf 210

**PD<sup>2</sup> = 5,7 kgf m<sup>2</sup>**  
**GD<sup>2</sup> = 5,7 kgf m<sup>2</sup>**

**Massima velocità di rotazione**  
Maximum rotation speed

<100°C = 2950  
100÷200°C = 2600  
200÷300°C = 2300

**Tolleranza sulla rumorosità + 3 dB(A)**  
Noise tolerance + 3 dB(A)

**Tolleranza sulla potenza assorbita ± 3%**  
Absorbed power tolerance ± 3%

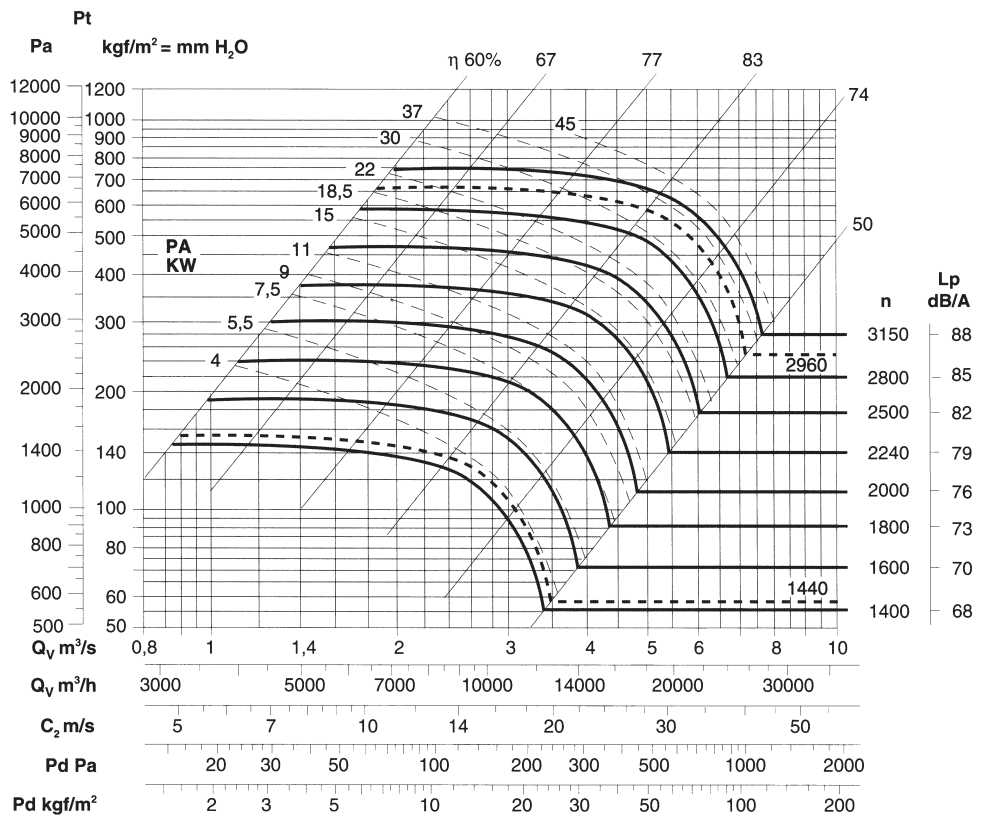



# PRESTAZIONI VENTILATORI A TRASMISSIONE BELT DRIVEN FANS PERFORMANCES

## RU 710T

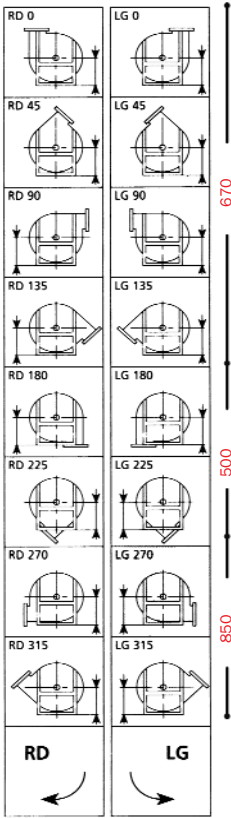

Il ventilatore **non** è orientabile  
The fan is **not** revolvable

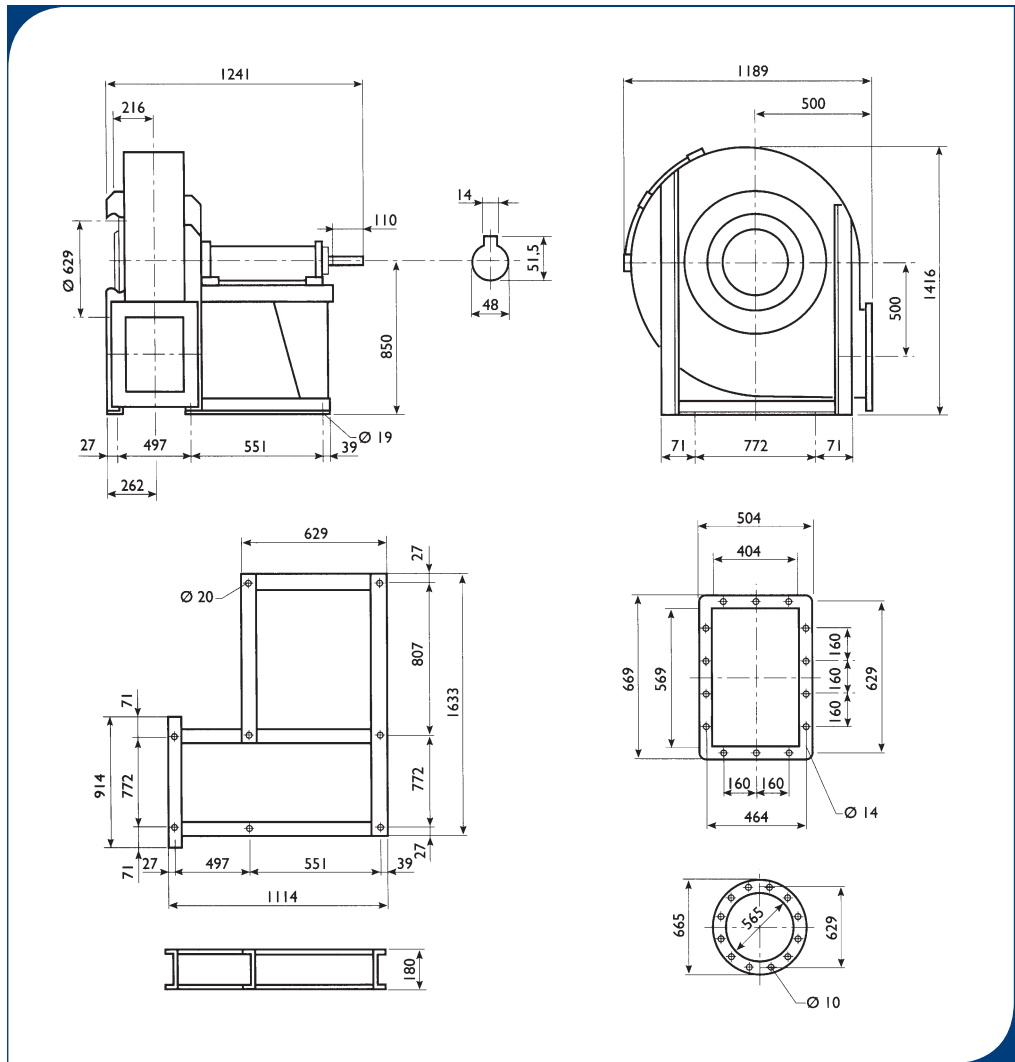

**Peso ventilatore in kgf 290**  
Weight of ventilator in kgf 290

**PD<sup>2</sup> = 11,5 kgf m<sup>2</sup>**  
**GD<sup>2</sup> = 11,5 kgf m<sup>2</sup>**

**Massima velocità di rotazione**  
Maximum rotation speed

<100°C = 2600  
100÷200°C = 2300  
200÷300°C = 2000

**Tolleranza sulla rumorosità + 3 dB(A)**  
Noise tolerance + 3 dB(A)

**Tolleranza sulla potenza assorbita ± 3%**  
Absorbed power tolerance ± 3%

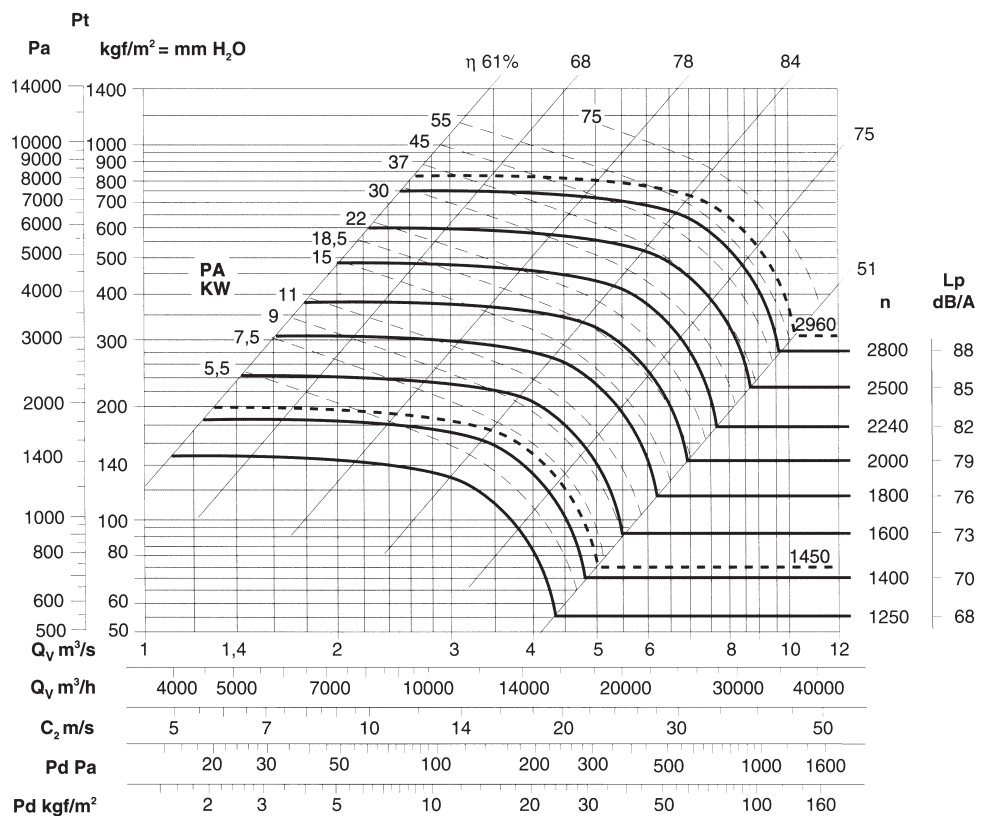





# PRESTAZIONI VENTILATORI A TRASMISSIONE BELT BELT DRIVEN FANS PERFORMANCES



## RU 1000T

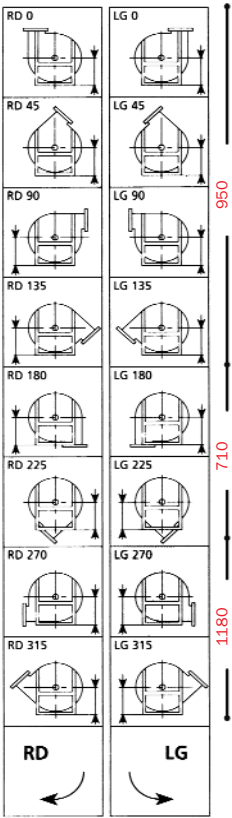

Il ventilatore **non** è orientabile  
The fan is **not** revolvable

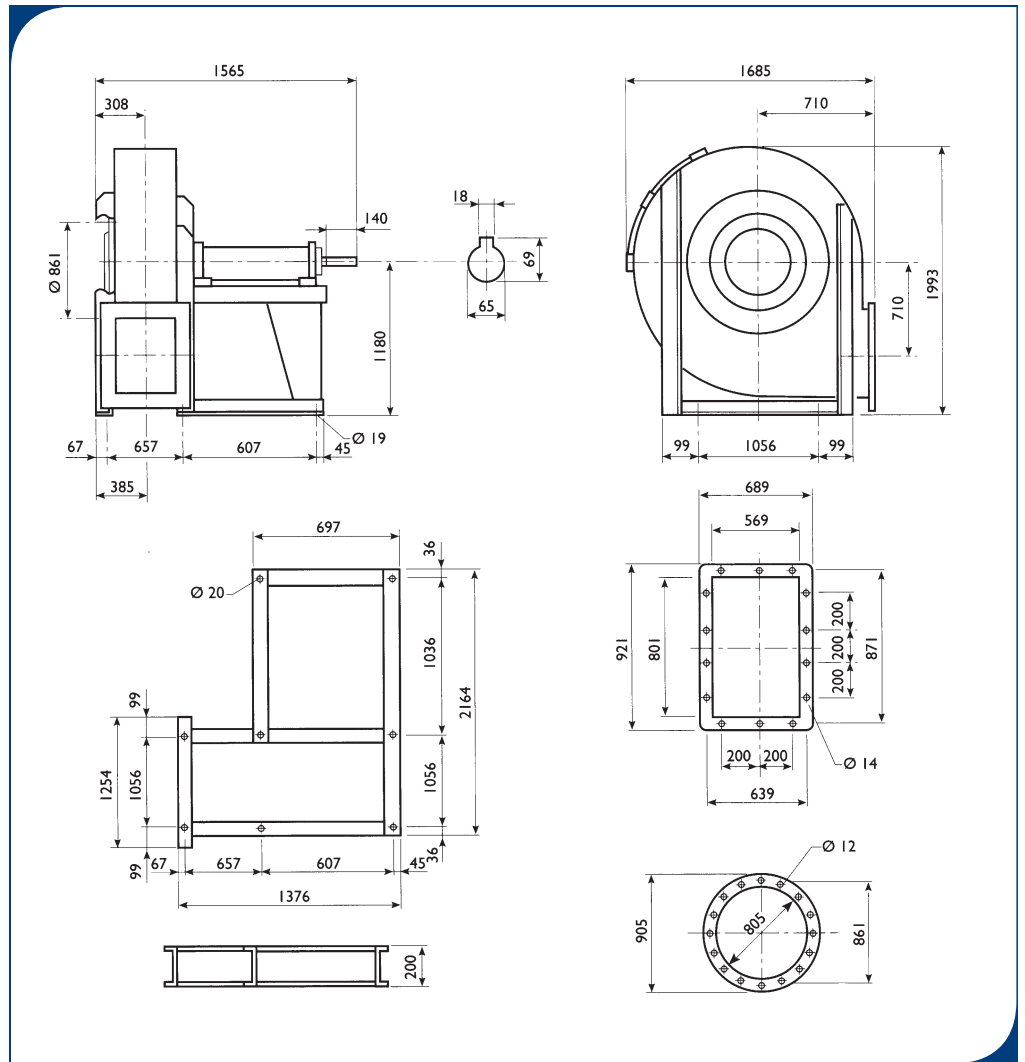

**Peso ventilatore in kgf 530**  
Weight of ventilator in kgf 530

**PD<sup>2</sup> = 72 kgf m<sup>2</sup>**  
**GD<sup>2</sup> = 72 kgf m<sup>2</sup>**

**Massima velocità di rotazione**  
Maximum rotation speed

<100°C = 1800  
100÷200°C = 1600  
200÷300°C = 1400

**Tolleranza sulla rumorosità + 3 dB(A)**  
Noise tolerance + 3 dB(A)

**Tolleranza sulla potenza assorbita ± 3%**  
Absorbed power tolerance ± 3%

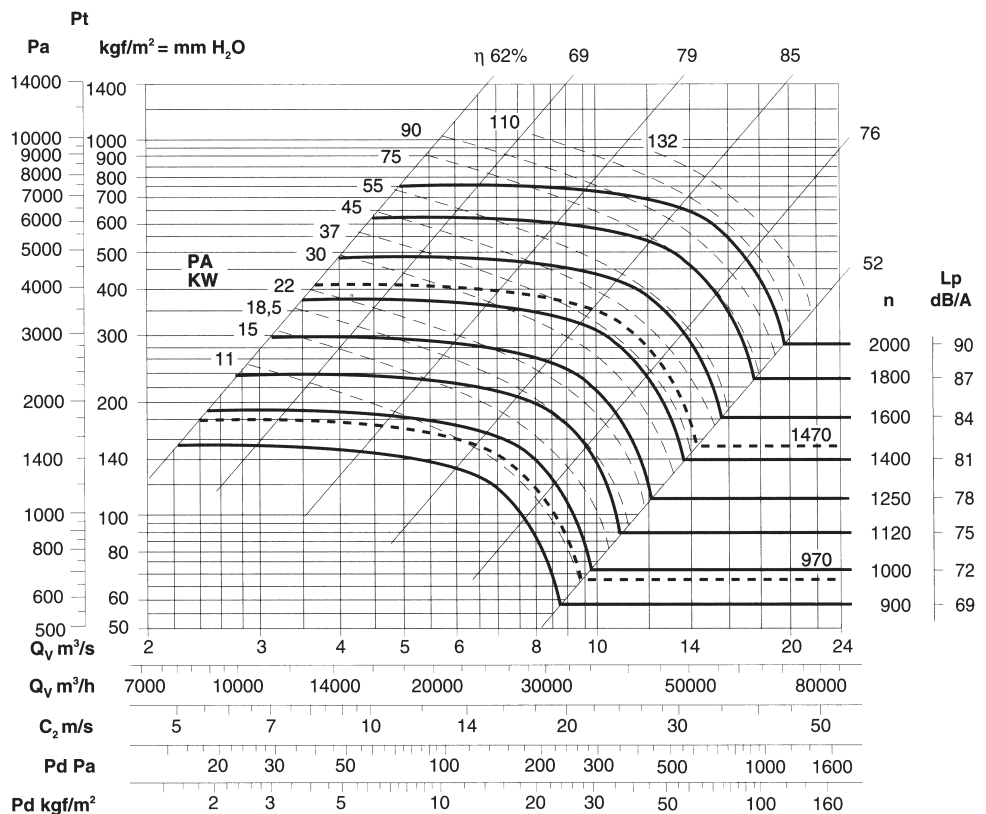





# PRESTAZIONI VENTILATORI A TRASMISSIONE

## BELT DRIVEN FANS PERFORMANCES

### RU 1120T

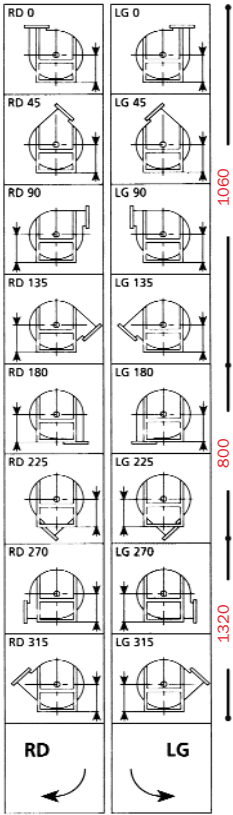

Il ventilatore **non** è orientabile  
The fan is **not** revolvable

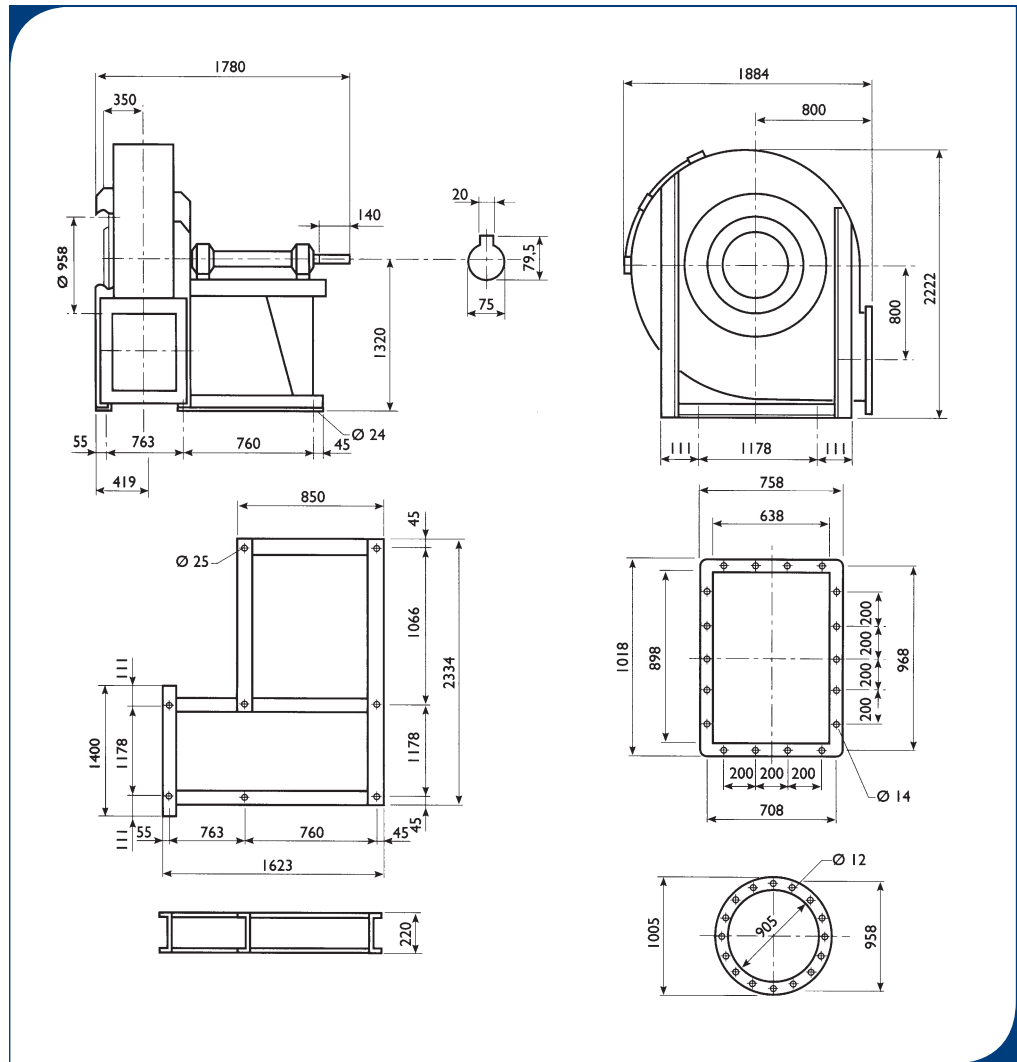

**Peso ventilatore in kgf 860**  
Weight of ventilator in kgf 860

**PD<sup>2</sup> = 90,5 kgf m<sup>2</sup>**  
**GD<sup>2</sup> = 90,5 kgf m<sup>2</sup>**

**Massima velocità di rotazione**  
Maximum rotation speed

<100°C = 1600  
100÷200°C = 1400  
200÷300°C = 1250

**Tolleranza sulla rumorosità + 3 dB(A)**  
Noise tolerance + 3 dB(A)

**Tolleranza sulla potenza assorbita ± 3%**  
Absorbed power tolerance ± 3%

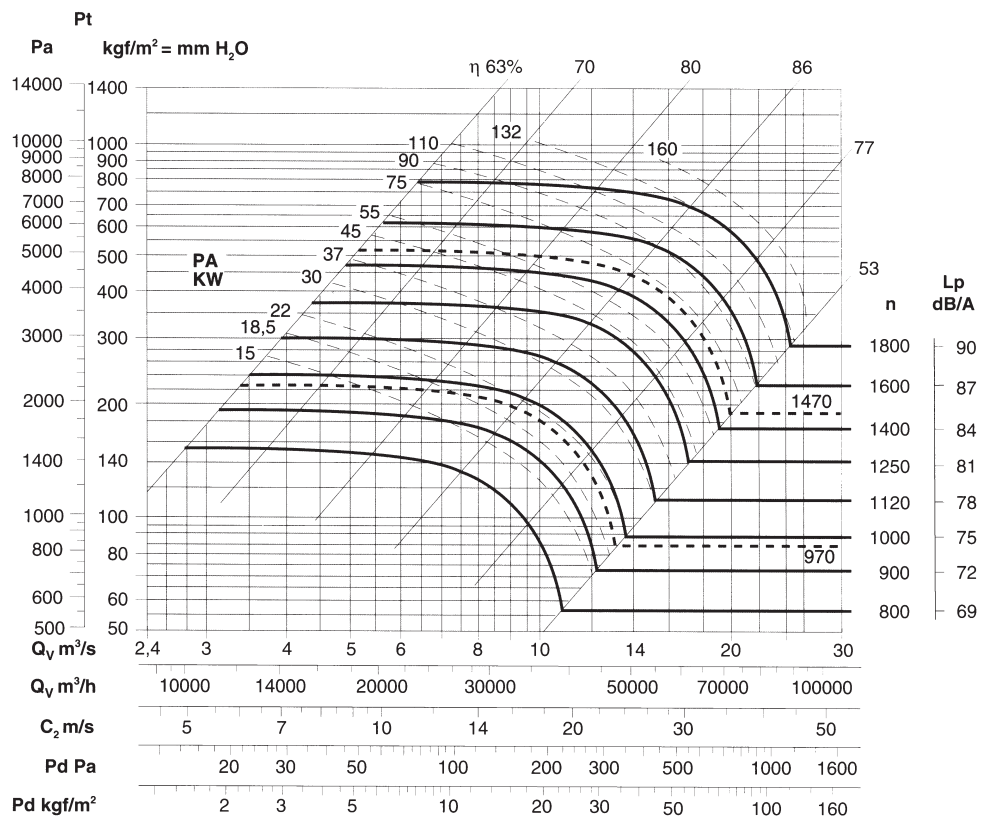

# PRESTAZIONI VENTILATORI A TRASMISSIONE BELT BELT DRIVEN FANS PERFORMANCES



## RU 1250T

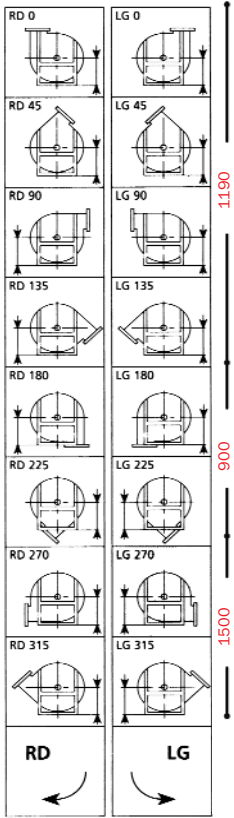

Il ventilatore **non** è orientabile  
The fan is **not** revolvable

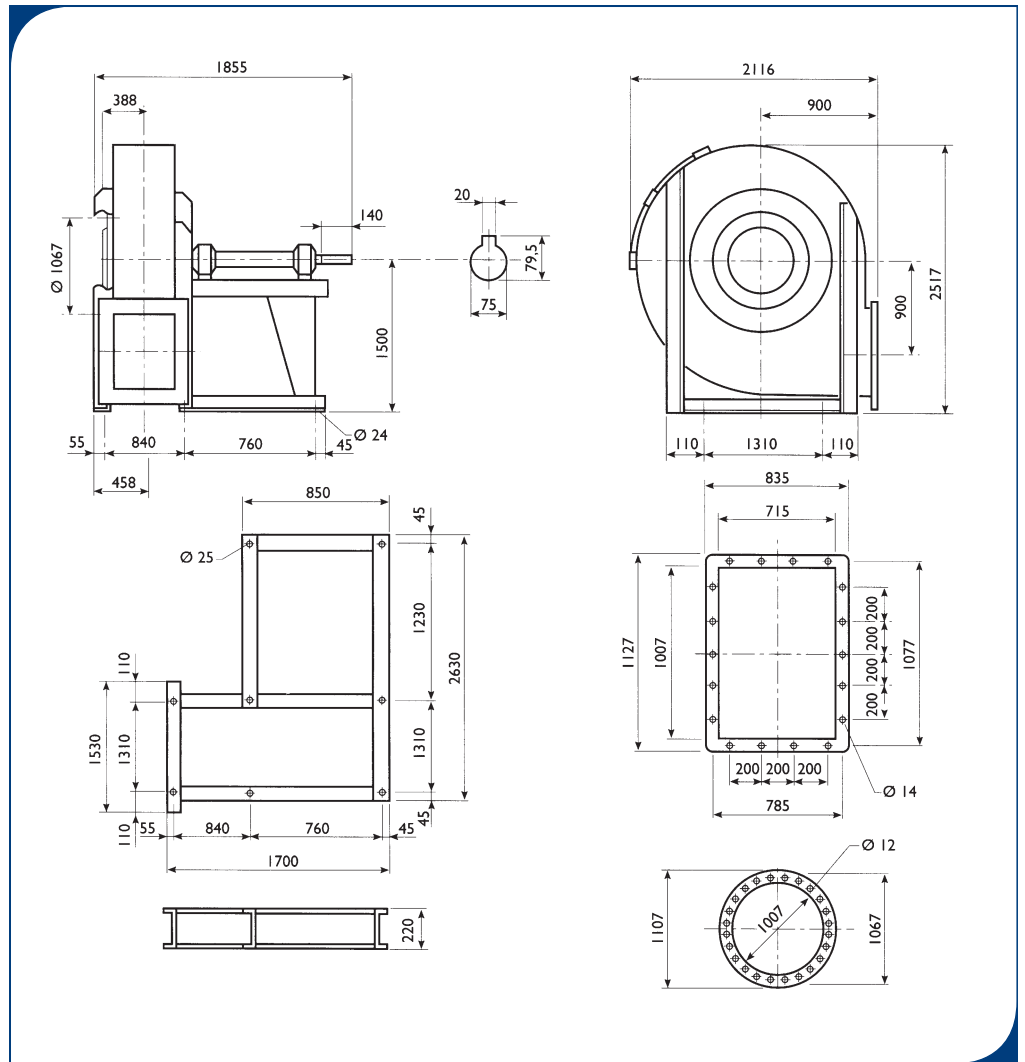

**Peso ventilatore in kgf 1095**  
Weight of ventilator in kgf 1095

**PD<sup>2</sup> = 161 kgf m<sup>2</sup>**  
**GD<sup>2</sup> = 161 kgf m<sup>2</sup>**

**Massima velocità di rotazione**  
Maximum rotation speed

<100°C = 1400  
100÷200°C = 1250  
200÷300°C = 1120

**Tolleranza sulla rumorosità + 3 dB(A)**  
Noise tolerance + 3 dB(A)

**Tolleranza sulla potenza assorbita ± 3%**  
Absorbed power tolerance ± 3%

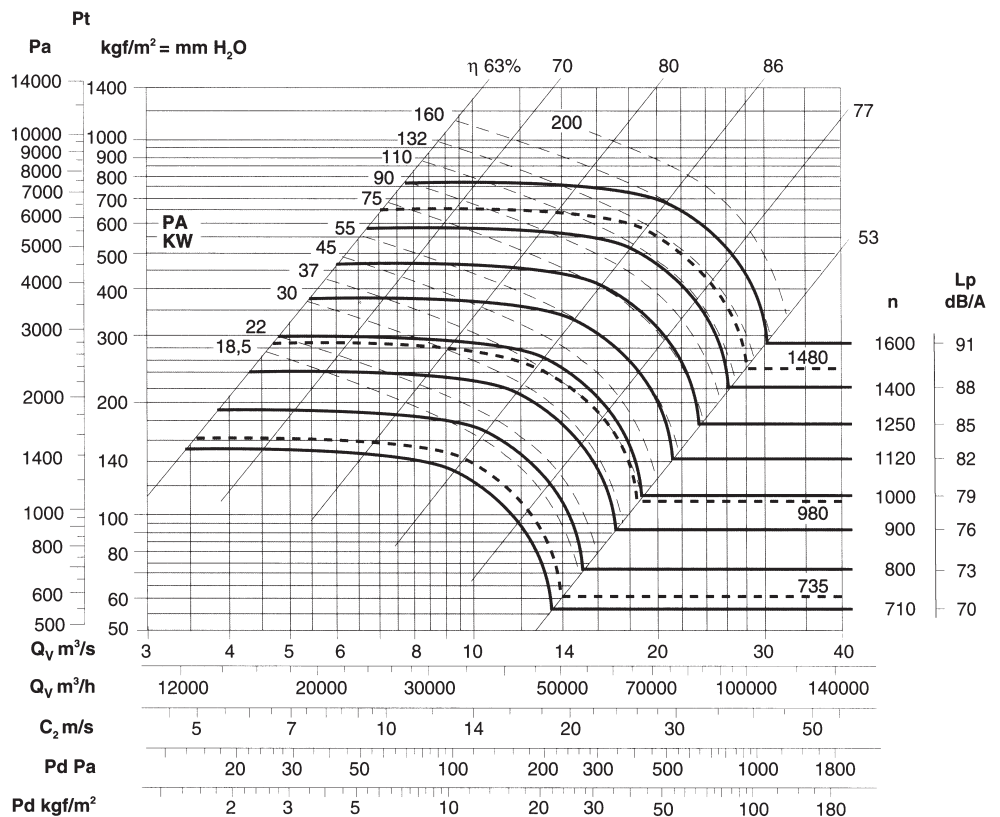



# PRESTAZIONI VENTILATORI A TRASMISSIONE BELT DRIVEN FANS PERFORMANCES

## RU 1400T

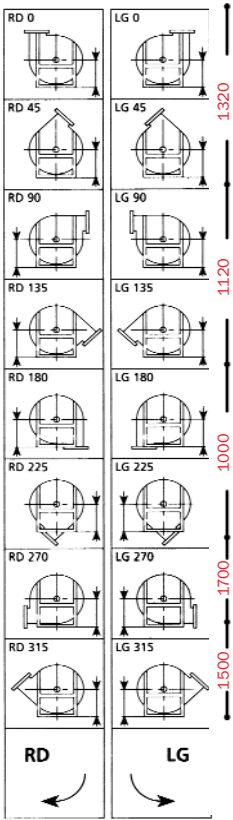

Il ventilatore **non** è orientabile  
The fan is **not** revolvable

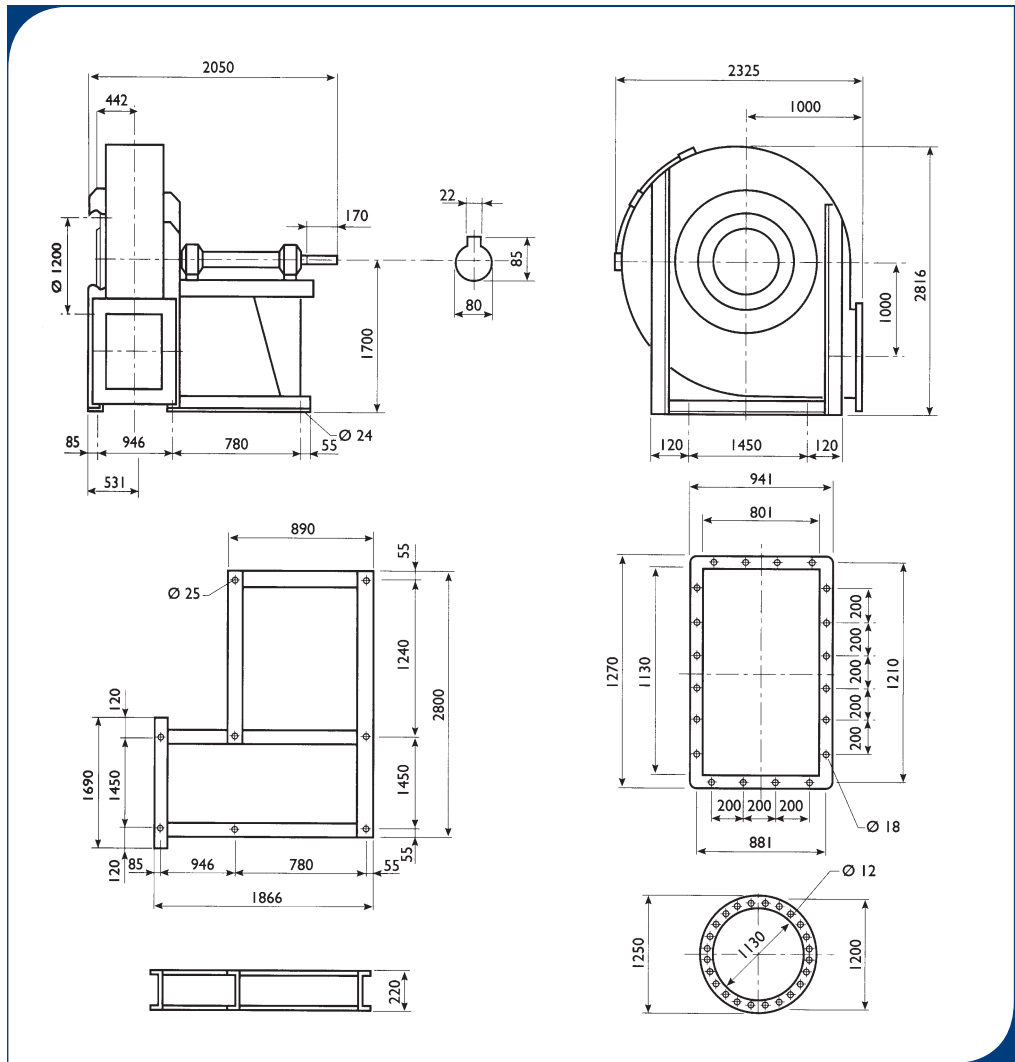

**Peso ventilatore in kgf 1510**  
Weight of ventilator in kgf 1510

**PD<sup>2</sup> = 266 kgf m<sup>2</sup>**  
GD<sup>2</sup> = 266 kgf m<sup>2</sup>

**Massima velocità di rotazione**  
Maximum rotation speed

<100°C = 1250  
100÷200°C = 1120  
200÷300°C = 1000

**Tolleranza sulla rumorosità + 3 dB(A)**  
Noise tolerance + 3 dB(A)

**Tolleranza sulla potenza assorbita ± 3%**  
Absorbed power tolerance ± 3%

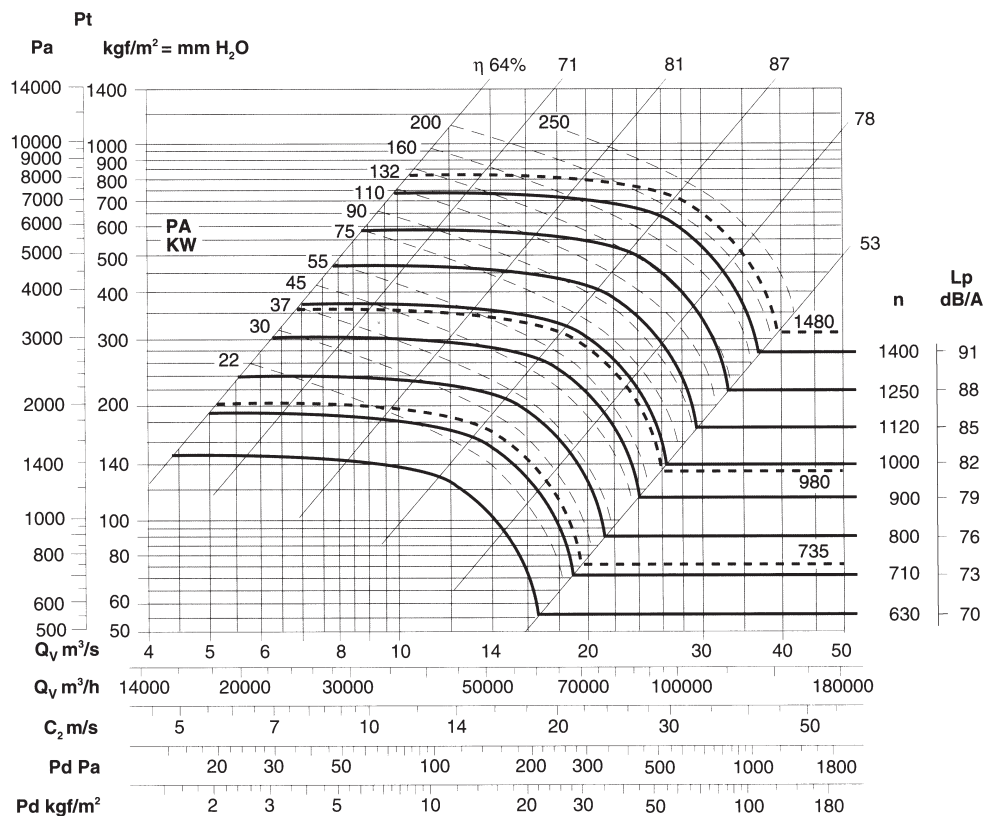

# PRESTAZIONI VENTILATORI A TRASMISSIONE BELT BELT DRIVEN FANS PERFORMANCES



## RU 1600T

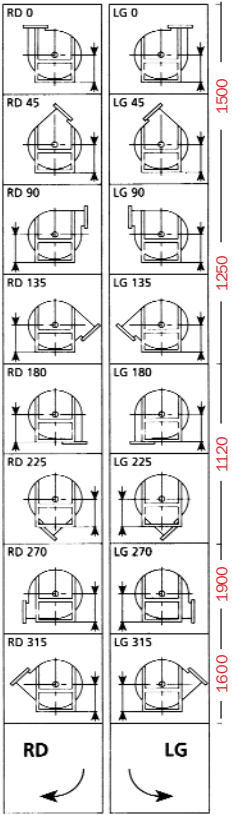

Il ventilatore **non** è orientabile  
The fan is **not** revolvable

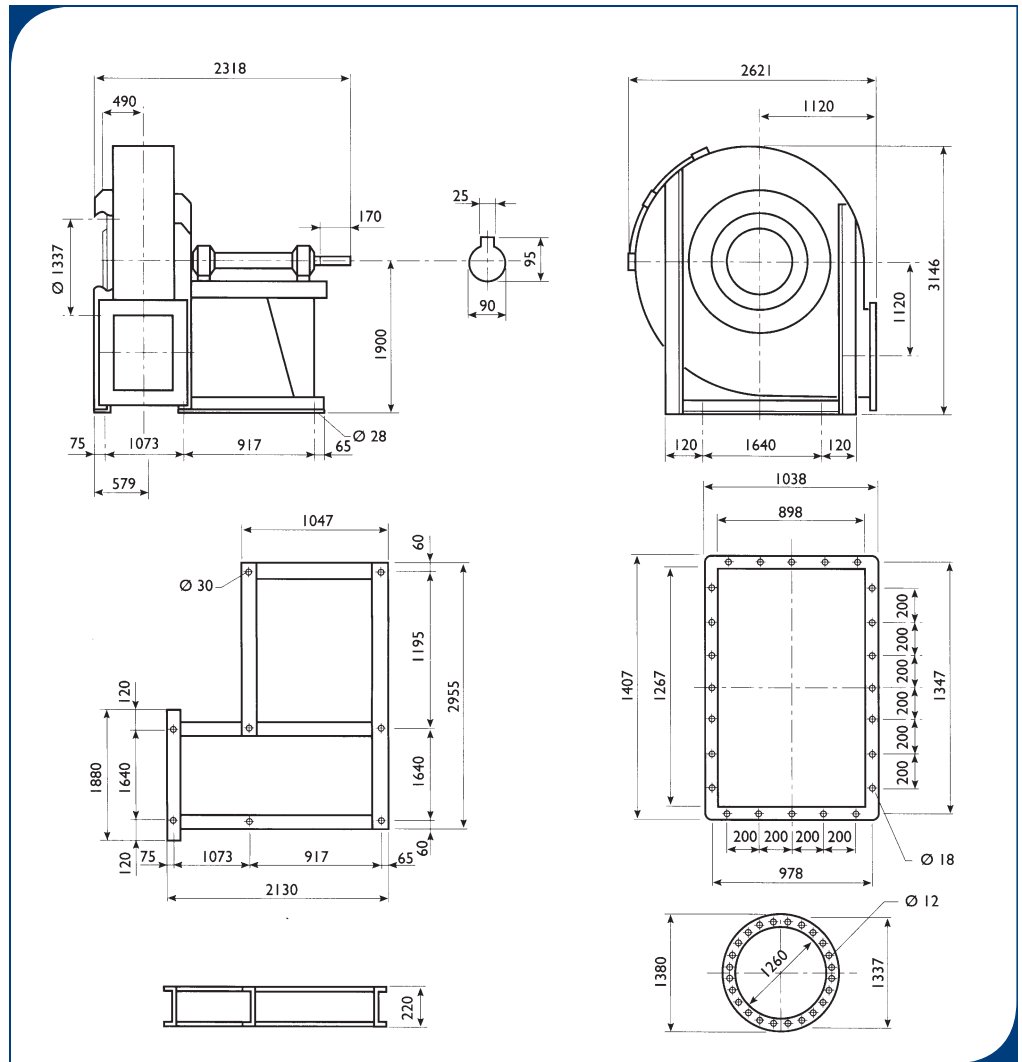

**Peso ventilatore in kgf 1980**  
Weight of ventilator in kgf 1980

**PD<sup>2</sup> = 476 kgf m<sup>2</sup>**

**Massima velocità di rotazione**  
Maximum rotation speed

<100°C = 1120  
100÷200°C = 1000  
200÷300°C = 900

**Tolleranza sulla rumorosità + 3 dB(A)**  
Noise tolerance + 3 dB(A)

**Tolleranza sulla potenza assorbita ± 3%**  
Absorbed power tolerance ± 3%

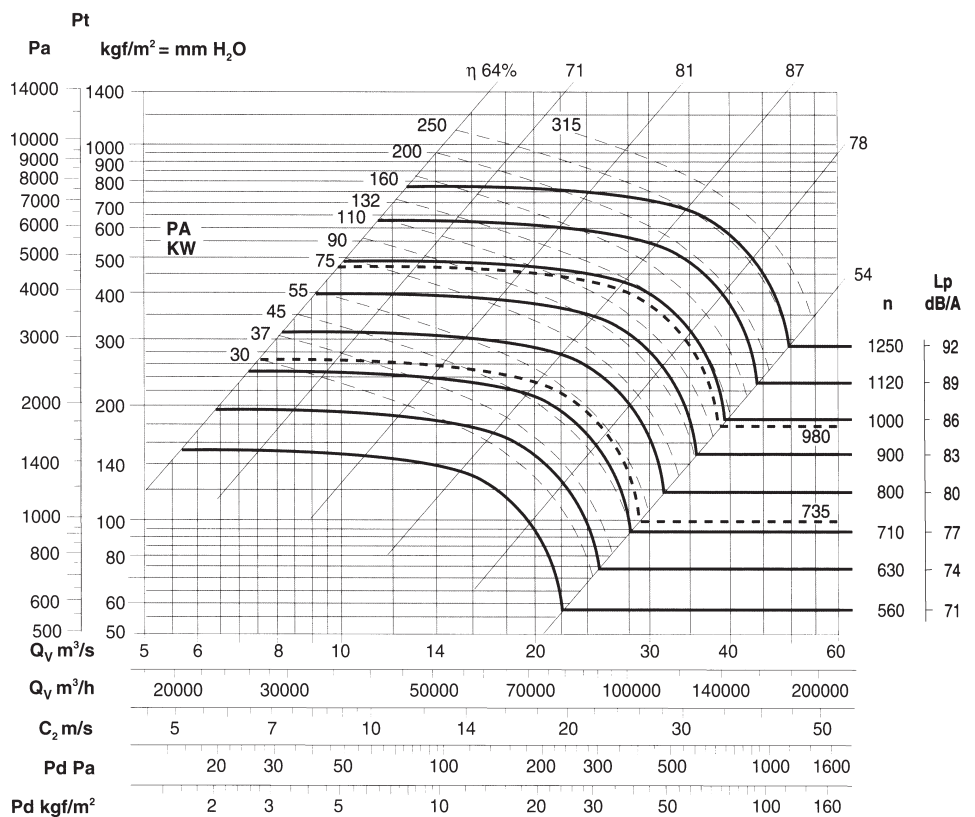

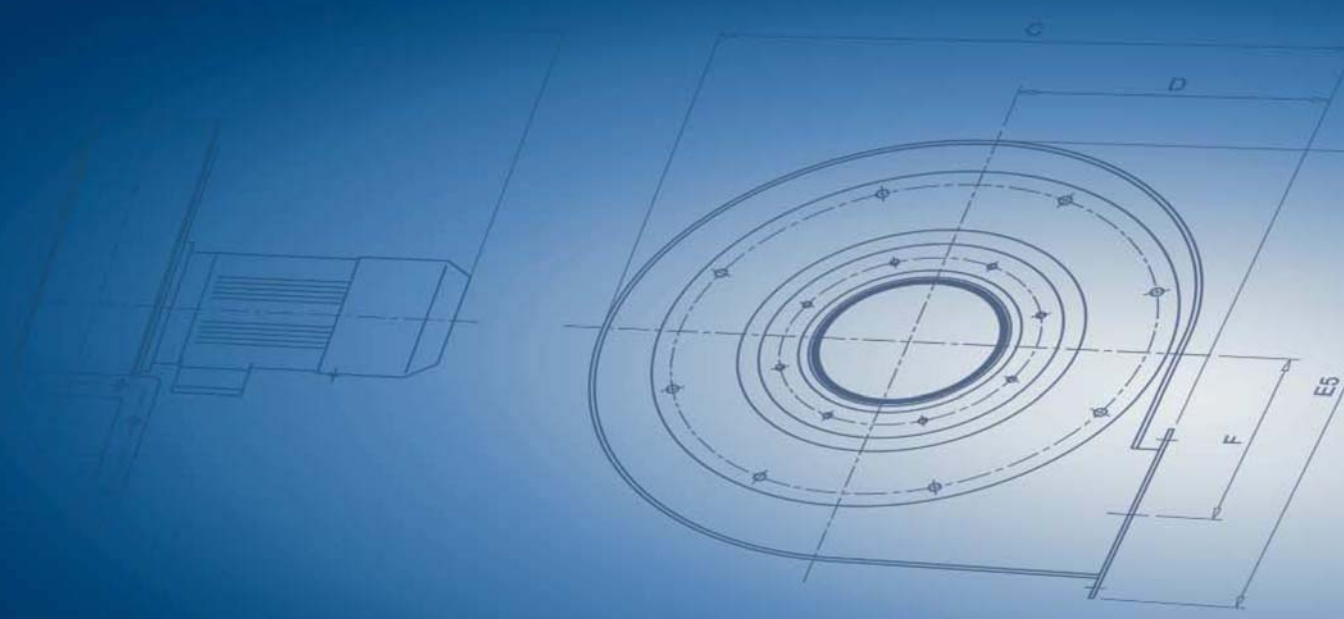

ACF Ventilatoren GmbH | Elf Stücken 21 | 49324 Melle | Tel.: +49(0)5422-9895-0 | Fax +49(0)5422-9895-15  
[www.acf-ventilatoren.de](http://www.acf-ventilatoren.de) | [info@acf-ventilatoren.de](mailto:info@acf-ventilatoren.de)